

HELI PROFESSIONAL

swissengineering RC Helicopter

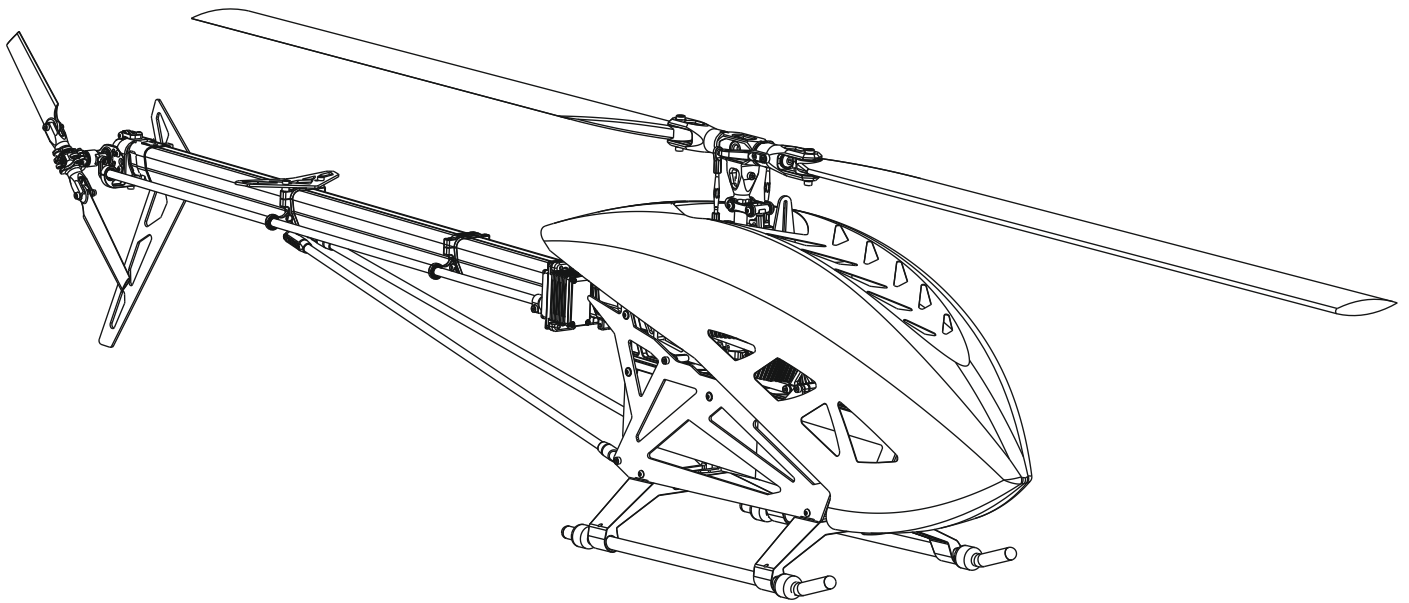

SOX05 STRIKE 7.1 LIGHT

Bauanleitung und Handbuch V 1.2
Assembly Instruction and Manual V 1.2

INHALT/CONTENT

Technische Daten & Sicherheitshinweise/Specifications & Safety Instructions

Benötigtes Werkzeug & Allgemeine Hinweise/Required Tools & General Information

Bauanleitung und Handbuch/Assembly Instructions and Manual

Explosionszeichnung/Exploded view

SEHR GEEHRTER KUNDE

BESTEN DANK, DASS SIE SICH FÜR DEN soXos STRIKE 7.1 Light ENTSCHIEDEN HABEN.

Bevor Sie mit dem Zusammenbau oder der Inbetriebnahme beginnen,
lesen Sie diese Anleitung bitte sorgfältig durch!

DEAR CUSTOMER,

THANK YOU FOR CHOOSING THE soXos STRIKE 7.1 Light MODEL HELICOPTER.

Before beginning with the assembly or operating the helicopter,
please read this manual thoroughly!

Technische Daten/Specifications

Hauptrotordurchmesser/Main Rotor Diameter:	ca. 1540mm (mit 690mm Blätter / with 690mm Blades)
Gewicht (ohne Komponenten und Blätter): Weight (without components and blades):	ca. 1880g
Gewicht 6S Setup (ohne Antriebsakku): Weight 6S Setup (without batteries):	ca. 3250g
Länge/Length:	ca. 1360mm
Höhe/Height:	ca. 340mm
Übersetzung Hauptrotor: Gear ratio main rotor:	1:7.94 - 1:10.06 Getriebe Übersetzungen: Ritzel sind kompatibel für 6mm und 8mm Motorwellen Gear Options: Pinions are suitable for 6mm and 8mm motorshafts 15 Zähne/Ratio: 10.06 17 Zähne/Ratio: 8.87 19 Zähne/Ratio: 7.94 16 Zähne/Ratio: 9.43 18 Zähne/Ratio: 8.38
Übersetzung Heckrotor: Gear ratio tail rotor:	1:5.05
Rotorblätter/Main blades:	685mm - 690mm
Heckrotorblätter/Tail blades:	105mm
Drehzahlbereich: Speed Range:	min. 1100 to max. 1900 UpM min. 1100 to max. 1900 Rpm
Maximale Abmessung des Antriebs-Akkus: Maximum dimension of the battery:	Breite 62mm, Höhe 68mm, Länge 350mm Width 62mm, Height 68mm, Length 350mm



Sicherheitshinweise:

Ein Modellhubschrauber ist kein Spielzeug, sondern ein sehr leistungsfähiges Flugmodell, das bei unsachgemäßer Bedienung und Wartung grossen Schaden an Mensch und Material verursachen kann. Kinder und Jugendliche sollten einen Modellhubschrauber nur unter Aufsicht eines sachkundigen Erwachsenen bedienen. Heli Professional kann für Haftungs- und Nachfolgeschäden von und mit Erzeugnissen aus dem Lieferprogramm nicht aufkommen und lehnt deshalb jegliche Haftung ab, da ein ordnungsgemäßer Betrieb oder Einsatz unsererseits nicht überwacht werden kann. Zudem bitten wir Sie, sich an die Bedienungsanleitung zu halten und nur Originalersatzteile von Heli Professional zu verwenden.



Safety Instructions:

A model helicopter is a very powerful flying device and not a toy. Disregarding our instructions, inappropriate use, and insufficient maintenance by persons lacking necessary competence may result in injuries for the user and can cause damage to the surroundings and to the model. Children and adolescents should operate a model helicopter only under supervision of an experienced adult. Heli Professional will not accept responsibility for any damage caused by their products and rejects any liability as we are not in a position to supervise proper operation, handling, and maintenance by the user. Furthermore, we ask you to follow our operating and assembly instructions carefully and to use only original Heli Professional parts.

Benötigtes Werkzeug/Required Tools

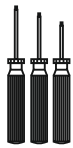

Innensechskantschlüssel
Hexagon Socket Wrenches
SW 1.5/2/2.5/3



Schraubensicherungslack, mittelfest und fest
Threadlocker, medium and strong

Sekundenkleber
CA (Cyanoacrylic Instant Adhesive)

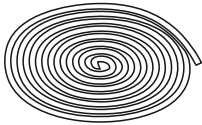

Schnur ca. 2m
String



Fett
Grease

Gabelschlüssel 5.5mm
Flat Wrench

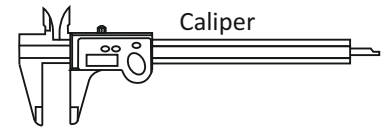
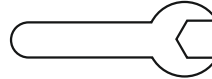

Messschieber
Caliper

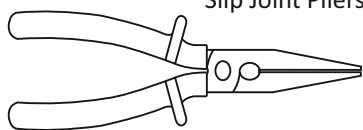

Kombizange
Slip Joint Pliers

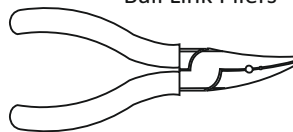

Kugelpkopzange
Ball Link Pliers



Kugelpkopfeindreher
Ball Link Driver

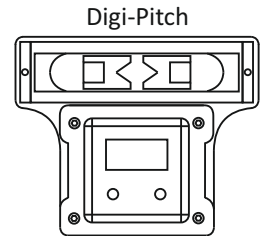

Digi-Pitch

Allgemeine Hinweise/General Information

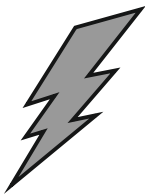

WICHTIG: Bevor Sie mit dem Zusammenbau oder der Inbetriebnahme beginnen, lesen Sie diese Anleitung bitte sorgfältig durch!

IMPORTANT: Before beginning with the assembly or operating the helicopter, please read this manual thoroughly!

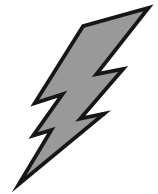

- Es sind keine elektronischen Bauteile, wie z.B. Servos, etc. im Lieferumfang enthalten.
- The kit does not include any electronic components such as servos, etc.

- Grundsätzlich muss jede Schraube entfettet und mit Sicherungslack eingeklebt werden. Auch bereits vormontierte Teile müssen diesbezüglich kontrolliert werden. Das rechts abgebildete Symbol soll Sie während des Zusammenbaus daran erinnern. Kugellager werden NICHT eingeklebt, ausser es wird darauf hingewiesen.
- In general, every screw must be cleaned and secured with threadlocker. Also, check preassembled parts regarding this. The symbol on the right-hand side is supposed to remind you while going through the assembly process. Ball bearings must NOT be secured with threadlocker except where noted.

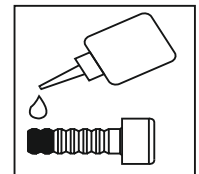

1:1

- Die in den Bauabschnitten mit diesem Symbol abgebildeten Schrauben, etc. sind in Originalgröße dargestellt.
- The screws and all other parts depicted with this symbol in the assembly steps are actual-size drawings.

- Achten Sie auf die Freigängigkeit aller verbauten Kugellager und Drucklager.
- Check all ball bearings and thrust bearings for ease of movement.

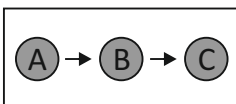
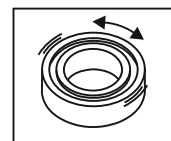

- Montieren Sie die Bauteile in der angegebenen Reihenfolge.
- Assemble the parts in the specified order.

- Wiederholen Sie den Montageschritt so oft wie angegeben (hier: zwei Mal).
- Repeat the assembly step as often as specified (here: twice).

2x

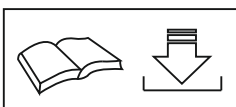



- Handbücher und Bauanleitungen für Tuningteile sind direkt von der Webseite zu beziehen.
- Manuals and assembly instructions for tuning parts are to be downloaded directly from the website. www.soxos-heli.com

Normteile/Standard Parts

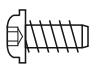
- 9** 3x7.5 Linsenkopf Treibschraube 8x
Flanged Round Head Self
Tapping Screw

- 8** 3x12 Treibschraube
Self Tapping Screw 2x



- 92** M3x6 Gewindestift
Set Screw 4x

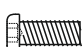

- 354** M3x8 Rundkopfschraube
Round Head Screw 8x

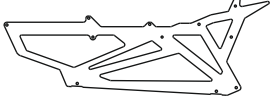

1:1

- 1979** Carbon Seitenplatte
Side Plate Carbon 2x

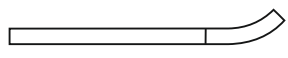

- 436** Kufenrohr
Skid Pipe 2x

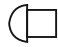

- 464** Kufengummi
Skid Rubber 4x

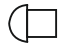

- 356** Endkappe Kufenrohr 4x
Skid Pipe Cap

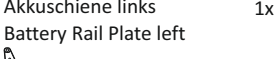

- 1664** Kufenhalterung 2x
Landing Skid Holder



- 275** Akkuschiene rechts
Battery Rail Plate right 1x

- 1624** Landegestell Weiss 2x
Landing Skid White

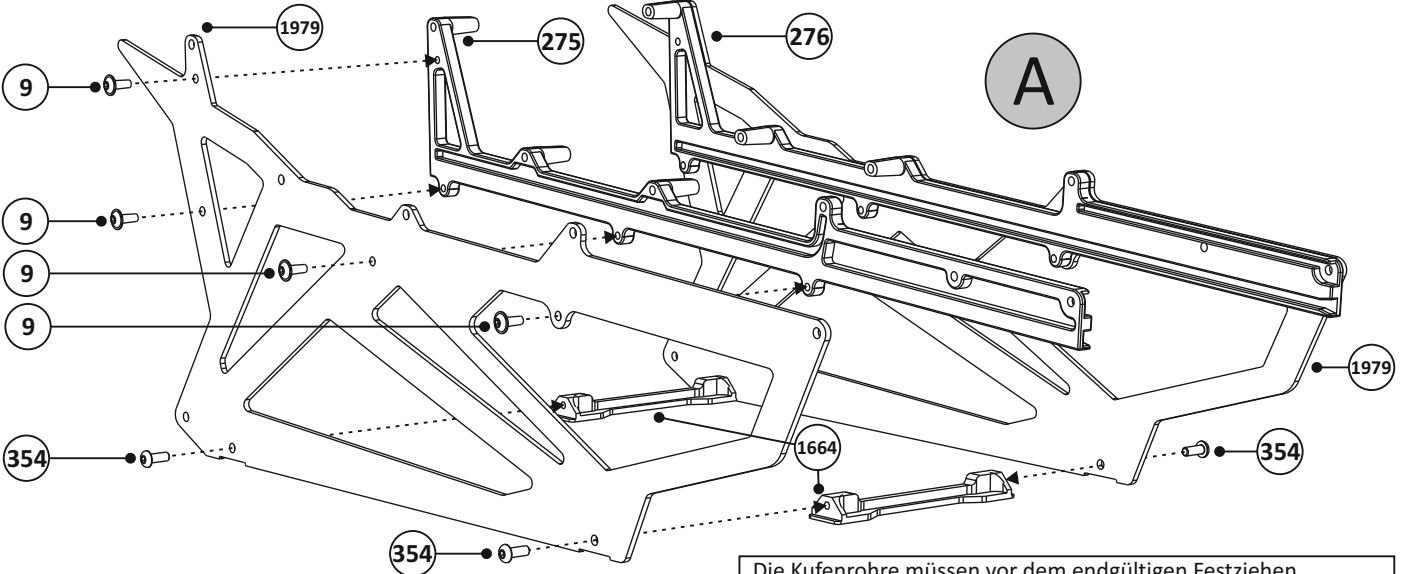

- 1625** Haubenhalterung 1x
Canopy Support
landing skid

- 276** Akkuschiene links
Battery Rail Plate left 1x



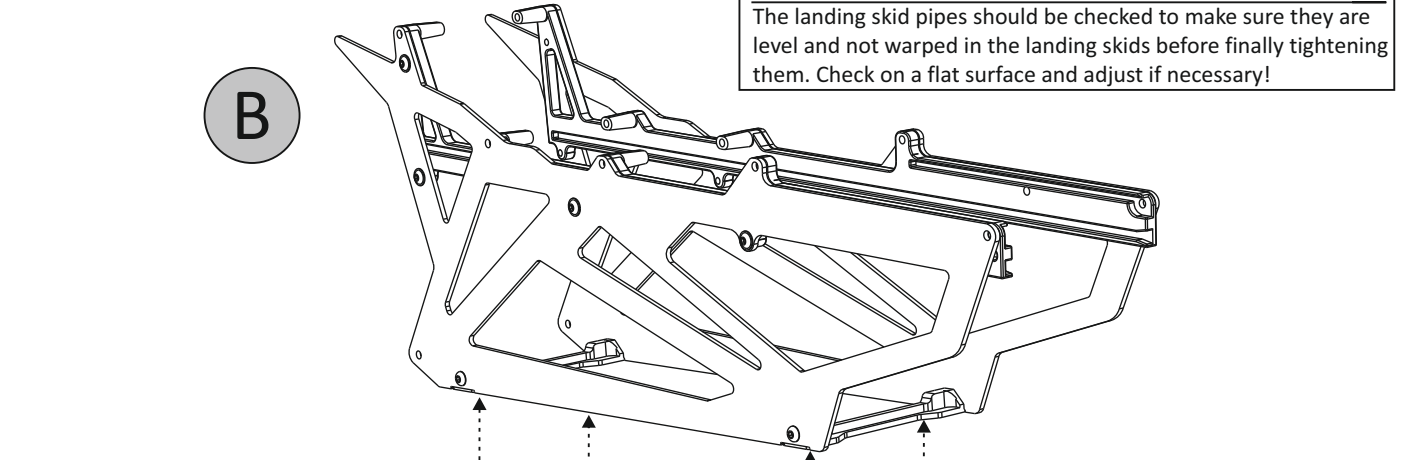

Die Kufenrohre müssen vor dem endgültigen Festziehen plan und ohne Spannungen im Landegestell aufliegen.
Auf einer ebenen Unterlage überprüfen und ggf. justieren!
The landing skid pipes should be checked to make sure they are level and not warped in the landing skids before finally tightening them. Check on a flat surface and adjust if necessary!



Endkappe Kufenrohr mit Sekundenkleber einkleben!
Use CA to secure the Skid Pipe Cap!

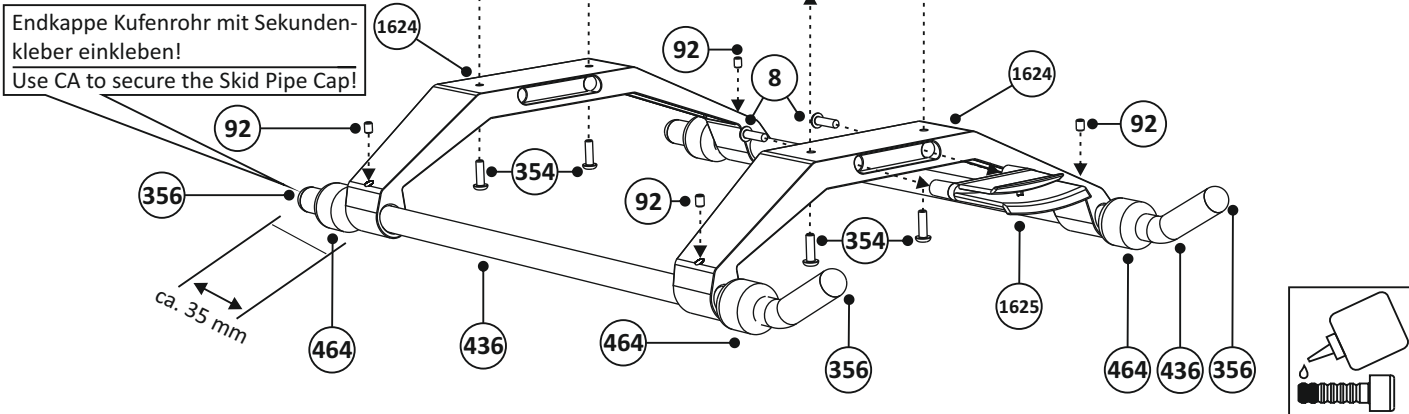

Normteile/Standard Parts

142 M3x22 Schraube
Hex Socket Screw 2x



105 M3x18 Schraube
Hex Socket Screw 1x



155 M3x6 Rundkopfschraube
Round Head Screw 6x



1705 3x8x3 Flanschlager
Flanged Bearing 6x



1706 Distanzhülse
Distance Sleeve 2x

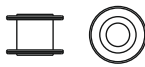

1741 Feder U-Scheibe
Spring Washer 1x



1738 Distanzhülse
Distance Sleeve 1x



1823 10x24x6 Flanschlager
Flanged Bearing 1x

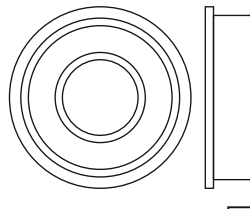

1:1

1777 Adapter Platte
Adapter Plate 1x



1766 Rahmen
Main Frame 1x

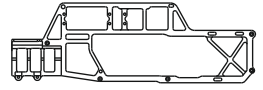

1680-01 Heckriemenführung
Tail Belt Guide 2x



1742 Zugfeder
Extension Spring 1x



1744 Klemmhebel
Gripping Lever 1x



2x **A**

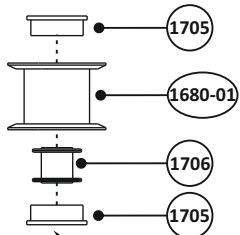

B

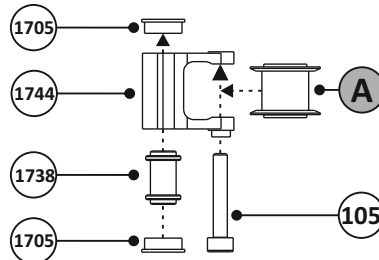

C

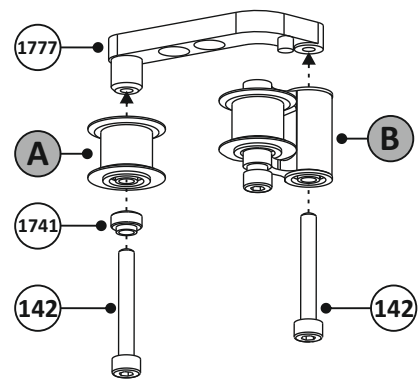

! Alle Kugellager in der Baugruppe A mit Sicherungslack einkleben!
Glue all ball bearings in the assembly A with strong threadlocker!

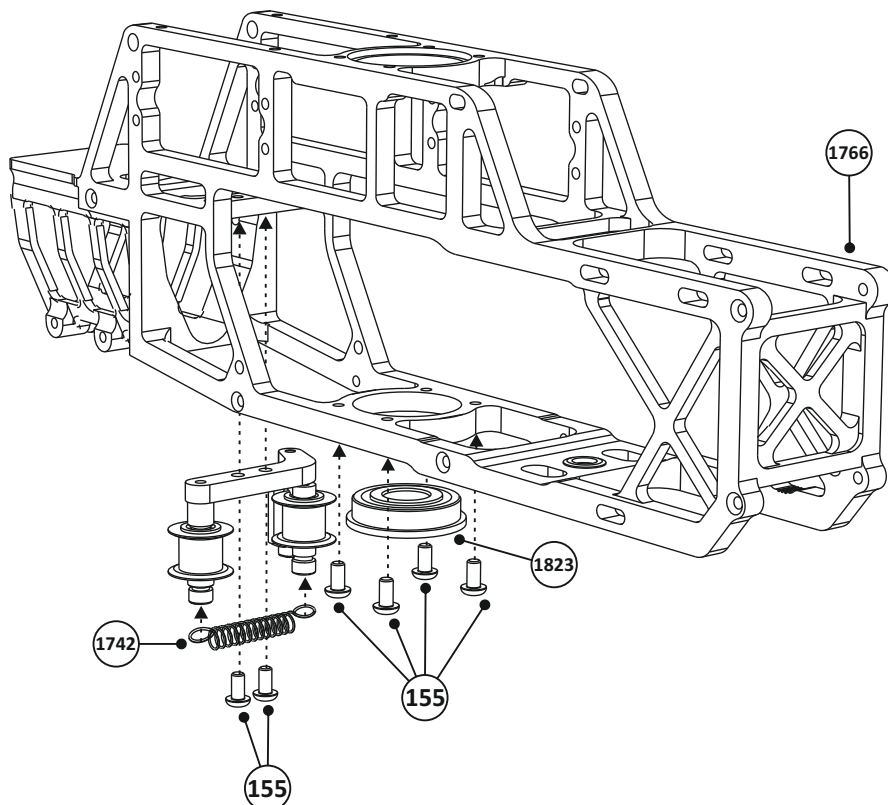

Normteile/Standard Parts

- 354 M3x8 Rundkopfschraube 12x Round Head Screw

1:1

- 1641-1 Hauptzahnrad Nabe 1x Main Drive Hub

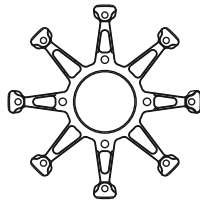

- 1643 Hauptzahnrad 81Z 1x Main Drive Gear 81T

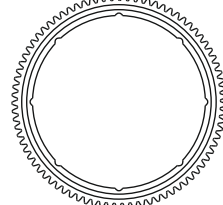

- 1822 Flanschmuffe 1x Flanged Sleeve

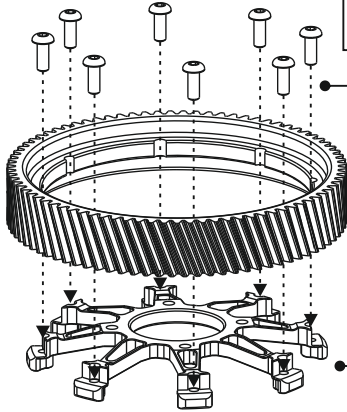
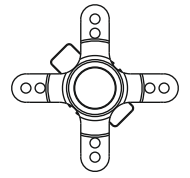

1643

1641-1

354

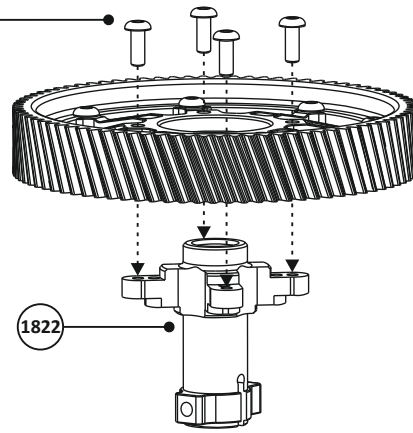

1822



Schrauben erst leicht eindrehen, danach gleichmässig anziehen!
First lightly seat the screws, then tighten them evenly!

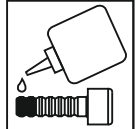

Normteile/Standard Parts

- 155 M3x6 Rundkopfschraube 4x Round Head Screw



- 487 M3x25 Spezialschraube 1x Special Screw



- 1823 10x24x6 Flanschlager 1x Flanged Bearing

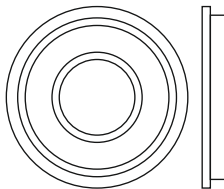

1:1

- 1743-06 Heckriemen 1x Tail Drive Belt



- 1842 Hauptrotorwelle 1x Main Shaft

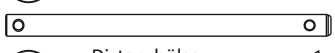

- 331 Distanzhülse 1x Hauptrotorwelle Distance Sleeve Main Shaft



- 1594 10x16x0.1 Passscheiben 2x Distance Washer



- 1595 10x16x0.2 Passscheiben 2x Distance Washer

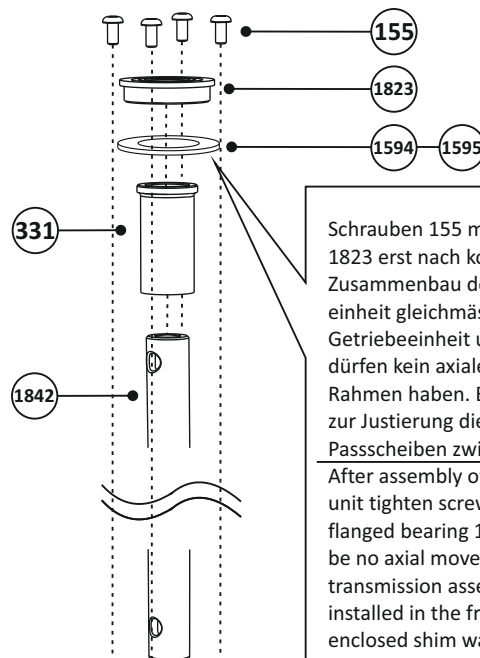

331

1842

155

1823

1594

1595



Schrauben 155 mit Flanschlager 1823 erst nach komplettem Zusammenbau der Getriebeeinheit gleichmässig anziehen. Getriebeeinheit und Rotorwelle dürfen kein axiales Spiel im Rahmen haben. Benutzen Sie ggf. zur Justierung die beiliegenden Passscheiben zwischen 1823 & 331. After assembly of the transmission unit tighten screws 155 on the flanged bearing 1823. There must be no axial movement of the transmission assembly when installed in the frame. Use the enclosed shim washers between 1823 & 331 if necessary.

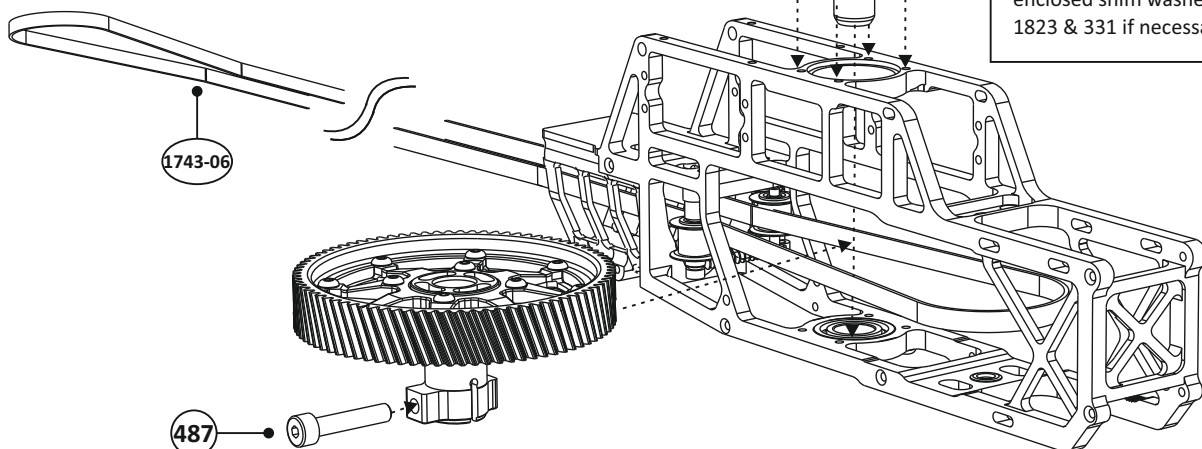



1743-06



487

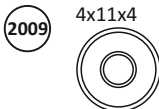
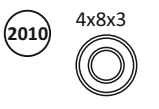

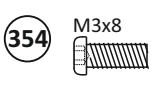
Normteile/Standard Parts

- 
2009 4x11x4 Kugellager / Ball Bearing 1x
- 
2010 4x8x3 Kugellager / Ball Bearing 3x
- 
303 M3x8 Zylinderkopfschraube / Socket Head Screw 4x
- 
354 M3x8 Rundkopfschraube / Round Head Screw 6x

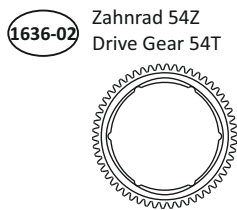
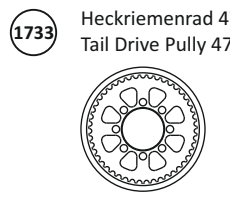
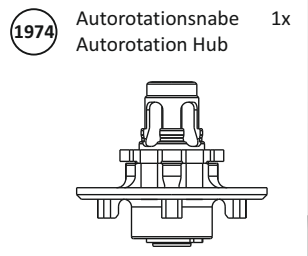
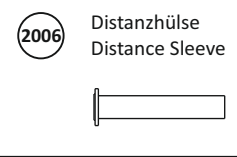
1:1

- 
1636-02 Zahnrad 54Z / Drive Gear 54T 1x
- 
1733 Heckriemenrad 47Z / Tail Drive Pulley 47T 1x
- 
1974 Autorotationsnabe / Autorotation Hub 1x
- 
2006 Distanzhülse / Distance Sleeve 1x
- 
2012 Zahnrad 29Z / Drive Gear 29T 1x

Werkseitig bereits montiert und gesichert.
Factory assembled and secured.

 Schrauben erst leicht eindrehen, danach gleichmässig anziehen!
First lightly seat the screws, then tighten them evenly!

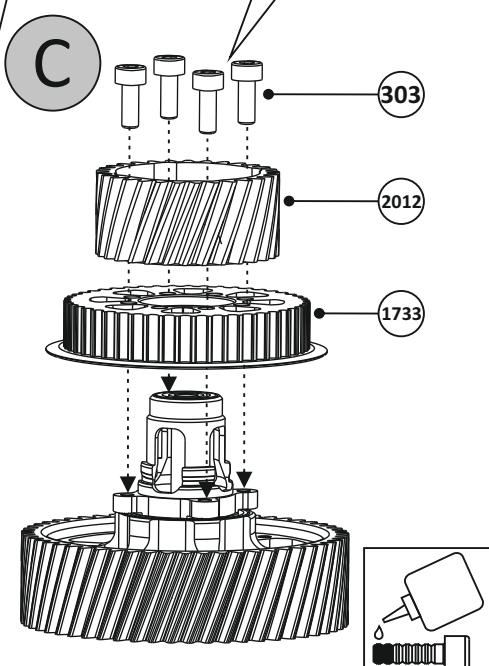
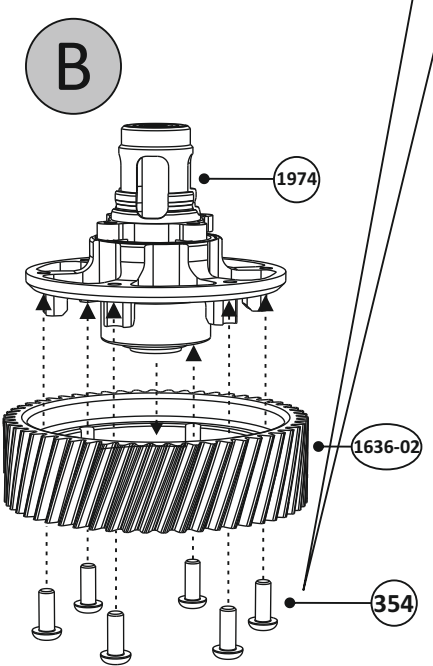
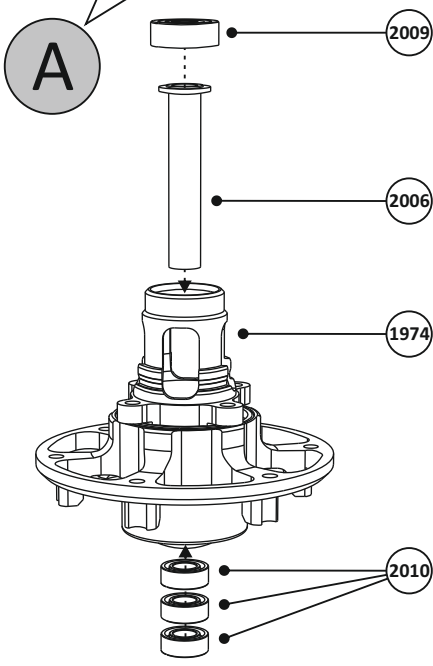

Normteile/Standard Parts

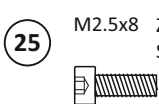
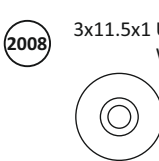
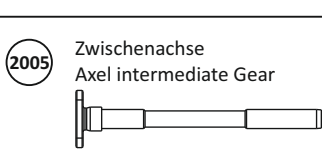
- 
25 M2.5x8 Zylinderkopfschraube / Socket Head Screw 1x
- 
2008 3x11.5x1 U-Scheibe / Washer 1x
- 
2005 Zwischenachse / Axel intermediate Gear 1x

1:1

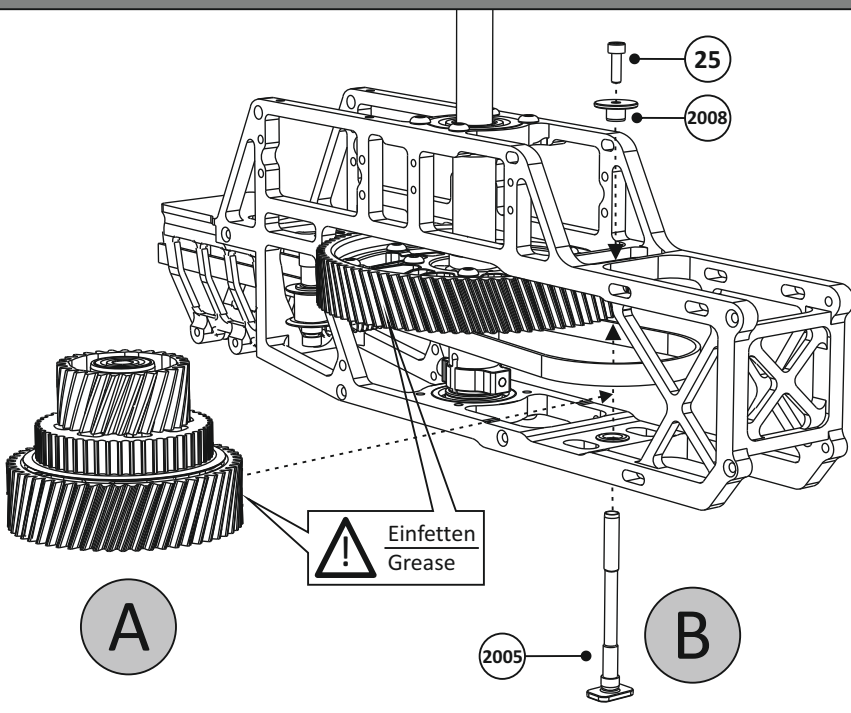

 Einfetten / Grease

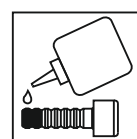

Normteile/Standard Parts

55 M3x25 Zylinderkopfschraube 6x
Socket Head Screw

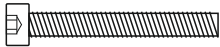

1:1

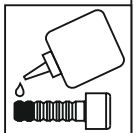
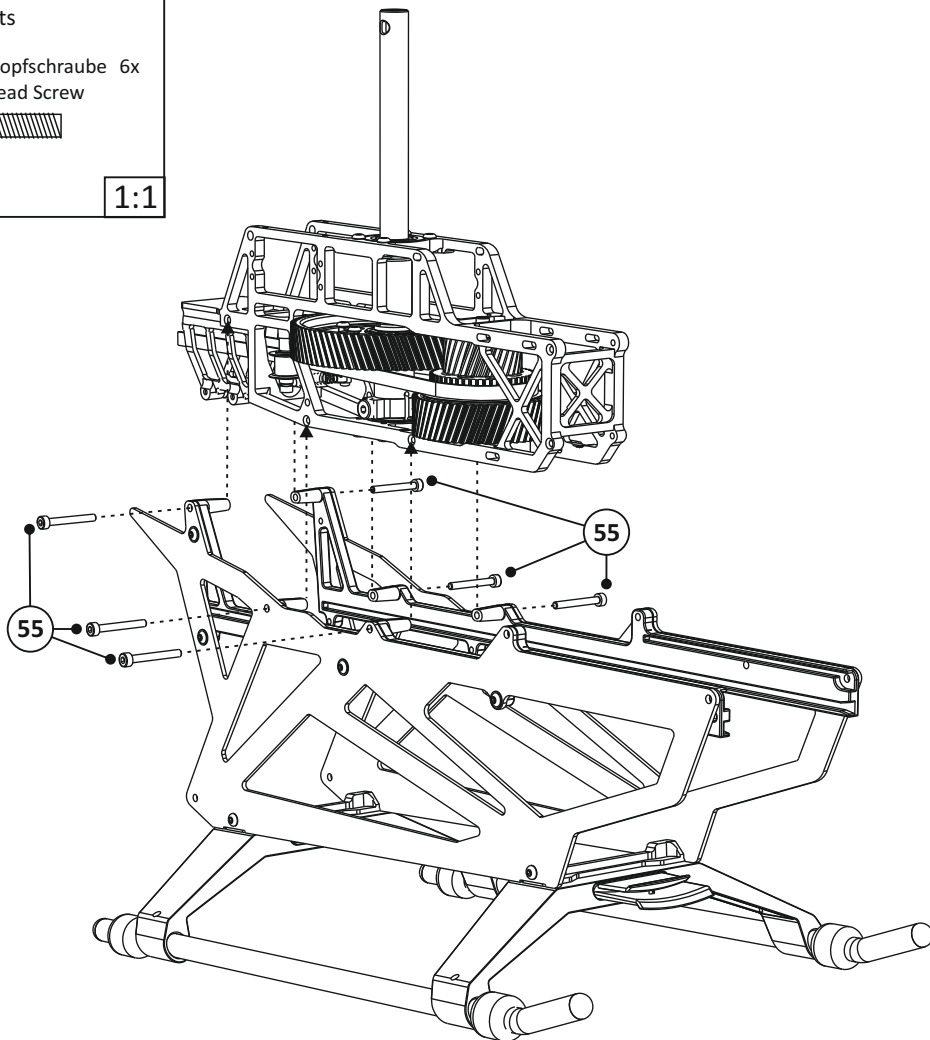

Normteile/Standard Parts

1684 M3x10 Rundkopfschraube 2x
Round Head Screw



155 M3x6 Rundkopfschraube 8x
Round Head Screw



1:1

1551 Vorbaudeckel
Porch Plate Top 1x

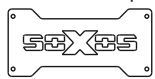

1552 Vorbauboden
Porch Plate Bottom 1x

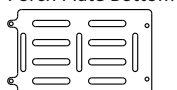

546 Bolzen Halterplatte
Bolt Box Plate 1x

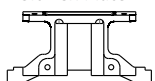

547 Halterung
Porch Holder 1x

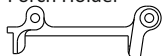

318 Verschluss
Latch 1x



350 Druckfeder
Pressure Spring 1x



319 Verschlussgehäuse
Bolt Box 1x

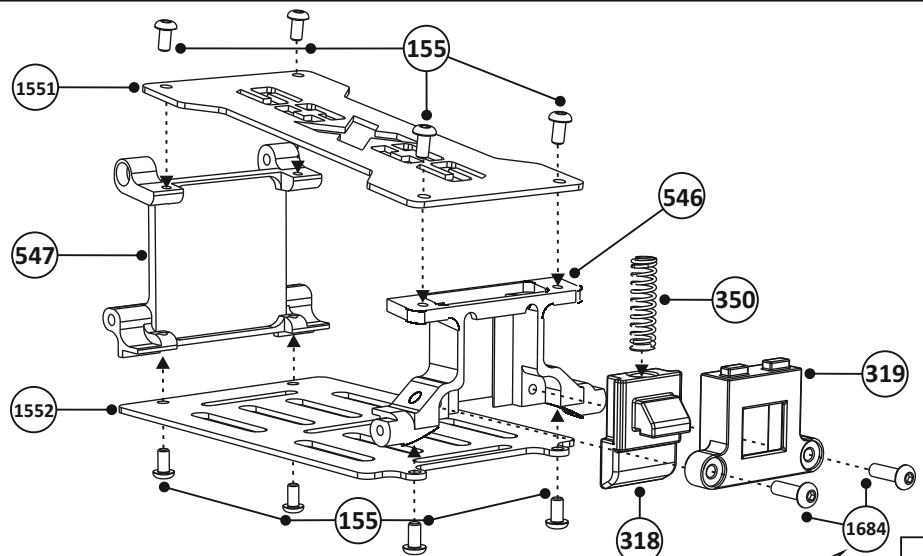

! Schraube 1684 nicht zu stark anziehen und auf Leichtgängigkeit des Verschlusses 318 achten!
Do not overtighten screw 1684 to keep smooth movement of latch 318!

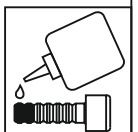

Normteile/Standard Parts

55 M3x25 Zylinderkopfschraube 2x
Socket Head Screw

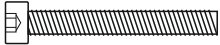

71 M3x10 Zylinderkopfschraube 2x
Socket Head Screw

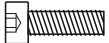



1684 M3x10 Rundkopfschraube 2x
Round Head Screw

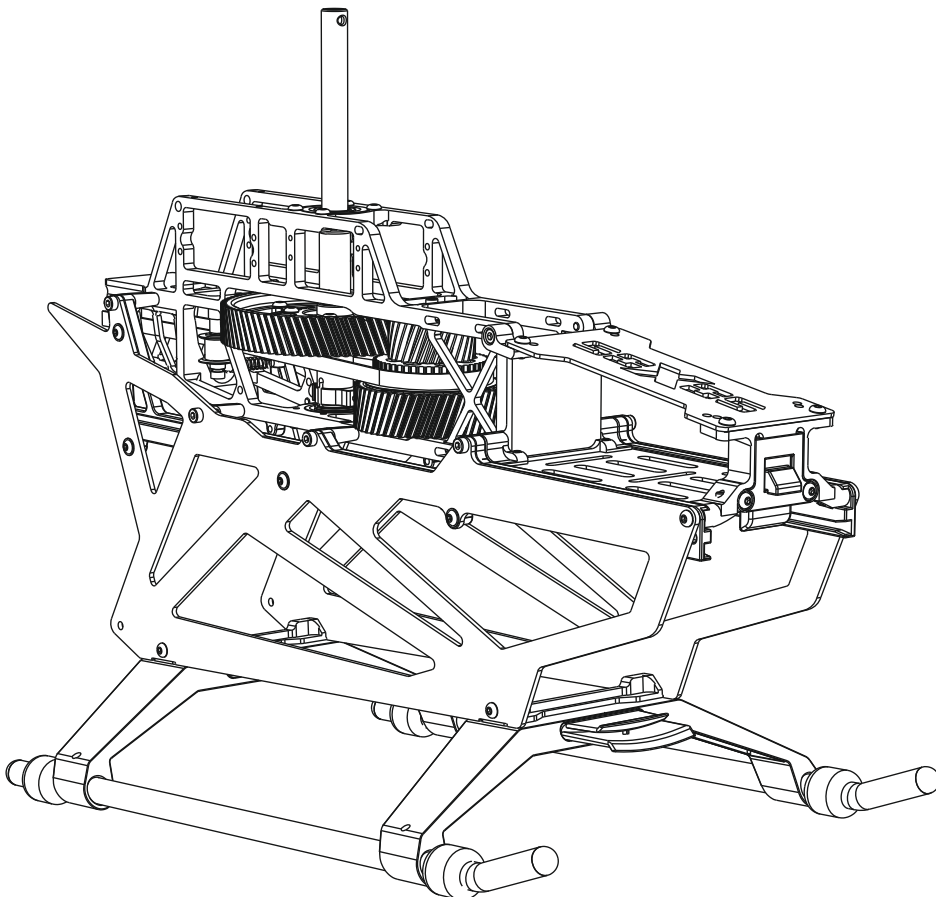
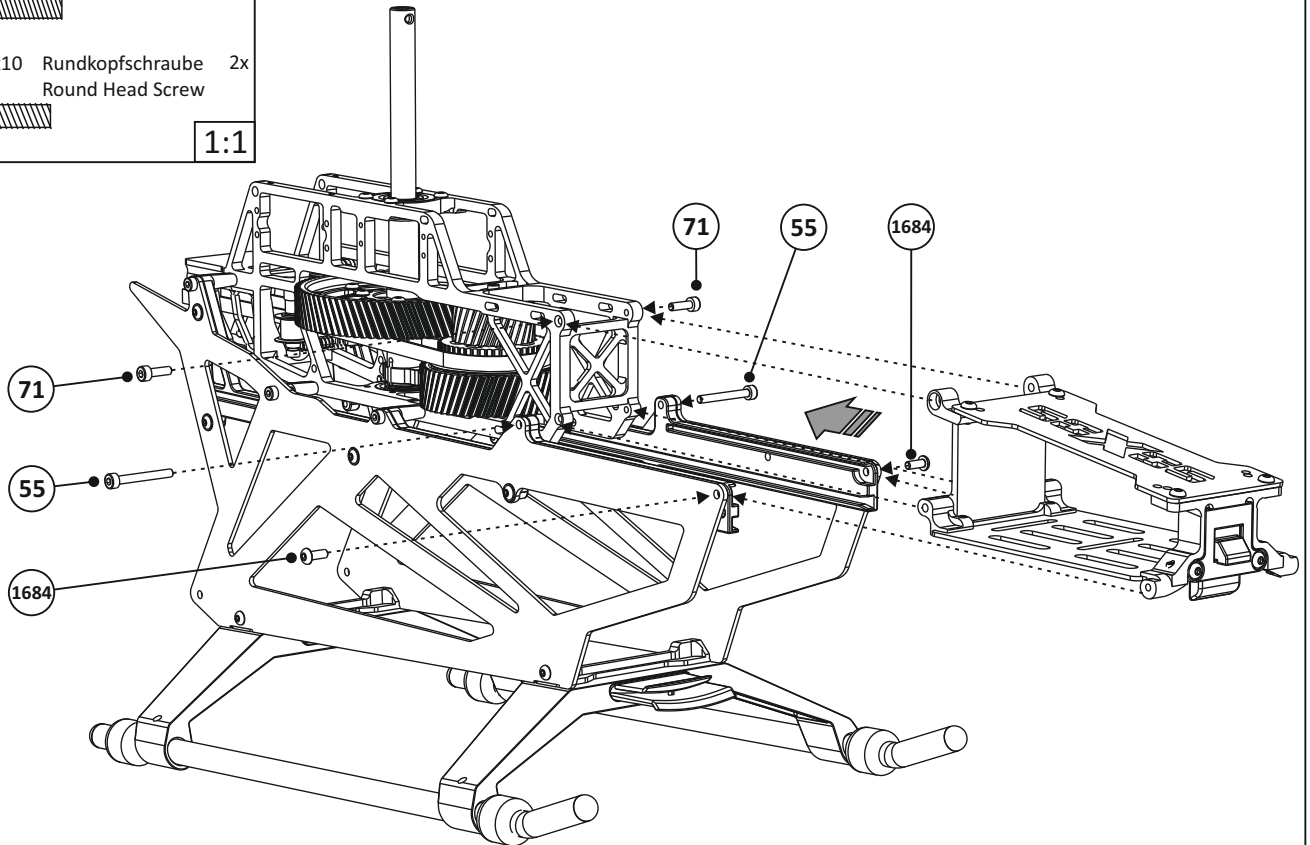

1:1

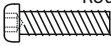

Normteile/Standard Parts

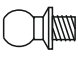
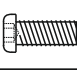
- 1600 M3x12 Rundkopfschraube 4x
 Round Head Screw

- 1601 M3x20 Rundkopfschraube 8x
 Round Head Screw

- 11 M3 U-Scheibe 12x
 Washer

- 145 M3x4.5 Kugelpfopf 3x
 Ball End Screw

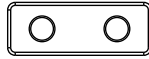
- 354 M3x8 Rundkopfschraube 3x
 Round Head Screw

1:1

137-01

Servodistanz 7 mm 4x
 Servo Distance Block



1665

Servodistanz 9.5 mm 4x
 Servo Distance Block



41

Servoplättchen 10x
 Servo Mounting Plates

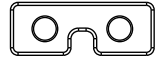

1659

Servo Einsatz 23Z,24Z,25Z,25Z/8
 Insert Servo 23T,24T,25T,25T/8



1797

Servoarm 3x
 Servo Horn



Je nach verwendeten Servos müssen Sie die unterschiedliche Einbautiefe der Servos durch die Verwendung des 7mm oder 9,5mm Servodistanzblocks ausgleichen. Für weitere Anpassungen können Sie die dünneren Servo-Montageplatten verwenden. Wichtig: Verwenden Sie auf jeder Seite die gleiche Anzahl an Servo-Montageplatten. Alle Teile auf Freigängigkeit prüfen. Die Servos dürfen sich nicht in der Mitte des Rahmens berühren. Die Schubstangen sollten so senkrecht wie möglich zur Taumelscheibe sein.

Je nach Art des verbauten Servos können die Schrauben aus der Rahmeninnenseite herausragen.

Depending on the servos used, you must compensate the differing mounting depth of the servos by using the 7mm or 9.5mm servo distance block. For more adjustment you can use the thinner servo mounting plates. Important: Use the same amount of servo mounting plates on each side. Check all parts for ease of movement. The servos must not touch each other in the middle of the frame but the servo to swash links should be as close to vertical as possible.

Depending on the type of servo installed, the screws may protrude from the inside of the frame.

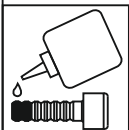
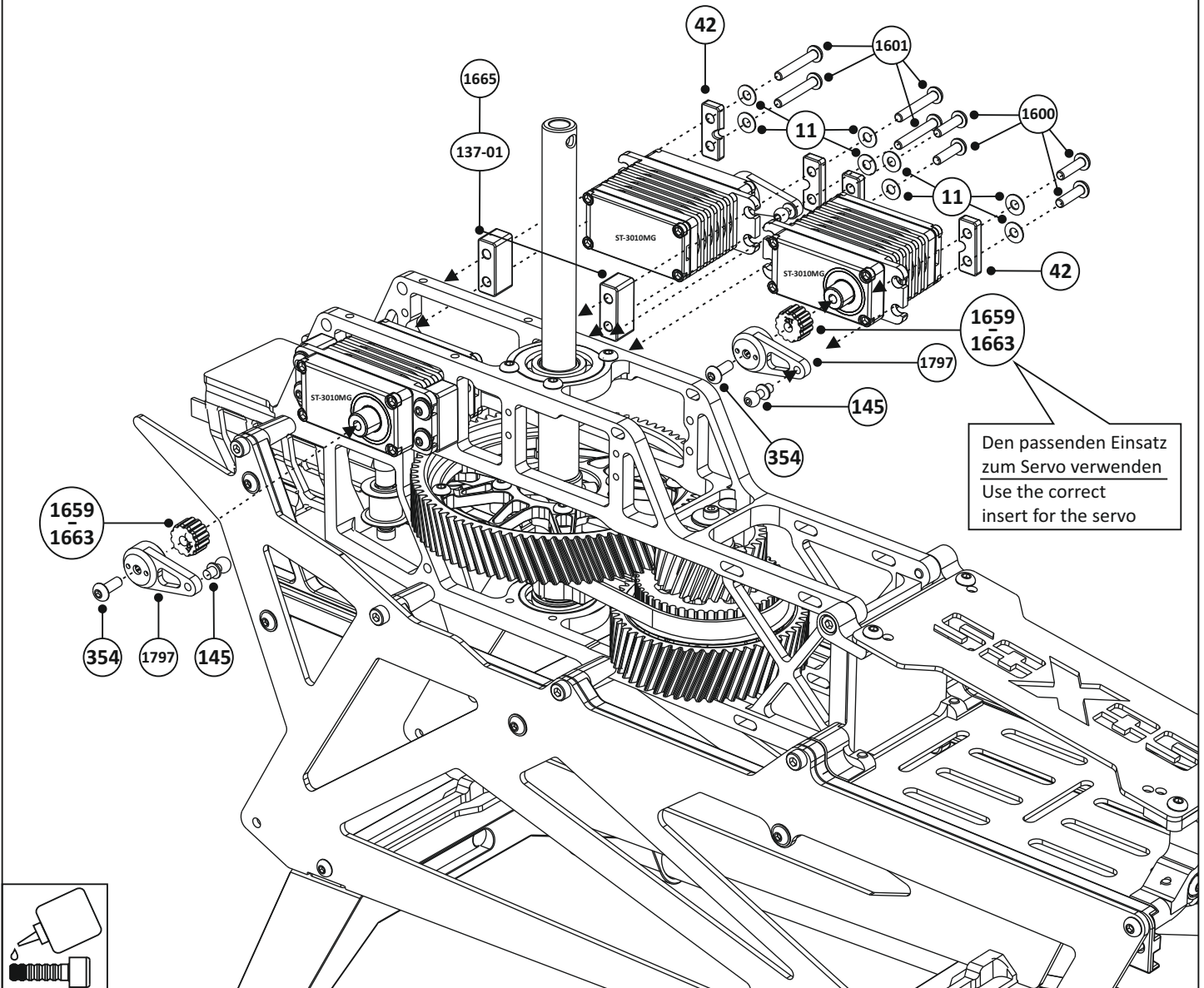

Normteile/Standard Parts

- 309** M3x7 Kugelpfanne 2x
Ball End Screw

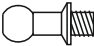
- 145** M3x4.5 Kugelpfanne 4x
Ball End Screw

- 549** M3x7 Kugelpfanne lang 1x
Ball End Screw long

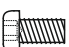

- 155** M3x6 Rundkopfschraube 2x
Round Head Screw

- 303** M3x8 Zylinderkopfschraube 2x
Socket Head Screw

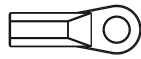

1:1

359 Kugelpfanne 6x
Ball Link



1790 Taumelscheibe 1x
Swashplate

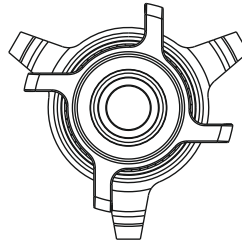

548 Taumelscheibenführungs- 1x
Halter
Swashplate Guide Holder



1798 Schubstange 3x
Control Rod

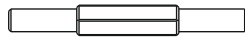

1799 Taumelscheibenführung 1x
Swashplate Guide

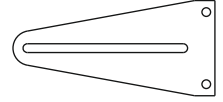

A

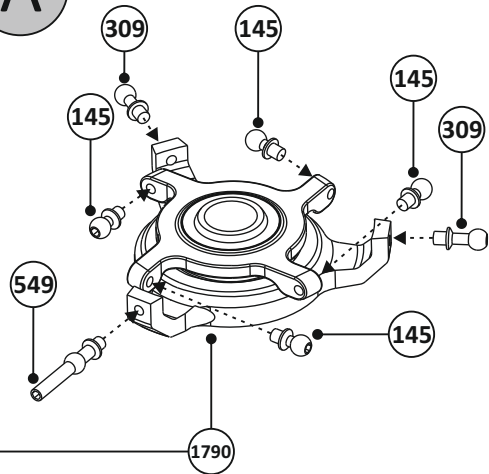

Schrauben Sie die Kugelpfannen 359 so weit wie möglich auf der Schubstange 1798 zusammen.
Screw ball links 359 together as far as possible on the control rod 1798!

B

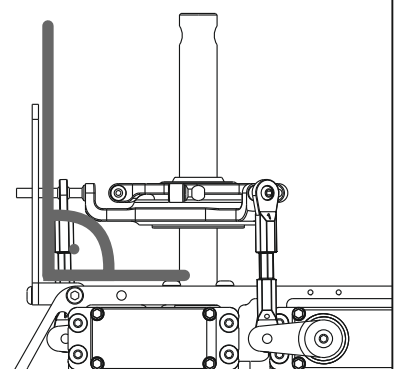
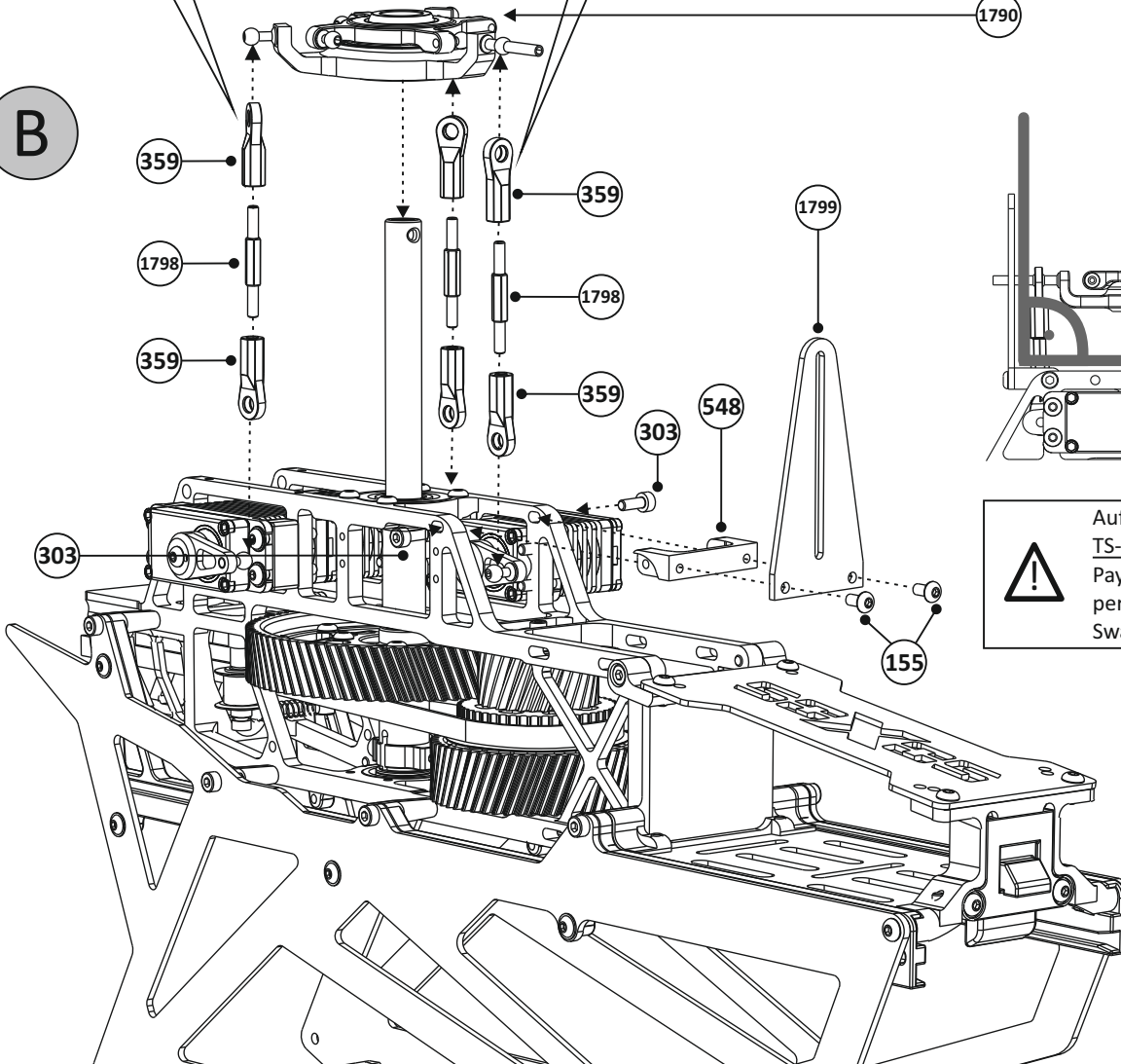

! Auf Rechtwinkligkeit der TS-Führung 1799 achten.
Pay attention to the perpendicularity of the Swashplate Guide 1799.



Normteile/Standard Parts

54	3x7x3	Flanschlager Flanged Bearing	4x	481	M5x12	Rundkopfschraube Round Head Screw	2x
47	8x11.6x0.5	Adapterscheibe Shim Washer	2x	21	M3x6	Zylinderschraube Socket Head Screw	4x
48	8x14x4	Kugellager / Ball Bearing	2x	155	M3x6	Rundkopfschraube Round Head Screw	2x
2000	8x16x5	Kugellager / Ball Bearing	2x	145	M3x4.5	Kugelpfanne Ball End Screw	2x
				2011		Kontrollstab Control Rod	1x

1:1

349	8x16x5	Drucklager Thrust Bearing	2x				
		large ID (IN)				small ID (OUT)	
1984		Dämpferhülse Damper Sleeve	2x	1813-70		Dämpfer 70° Damper 70°	4x
478		Blattlagerwelle Spindle Shaft					1x
369c		Mischebelarm Mixing Lever Arm	2x	1985		Blattlagerwellenführung Spindle Shaft Support	1x
2013		Zentralstück Main Hub	1x	1673		Kugelpfannhalter Ball Link Holder	1x
1982		Blatthalter Blade Holder	2x	1672		Mitnehmer Arm Mixing Lever	1x
359		Kugelpfanne Ball Link	1x				

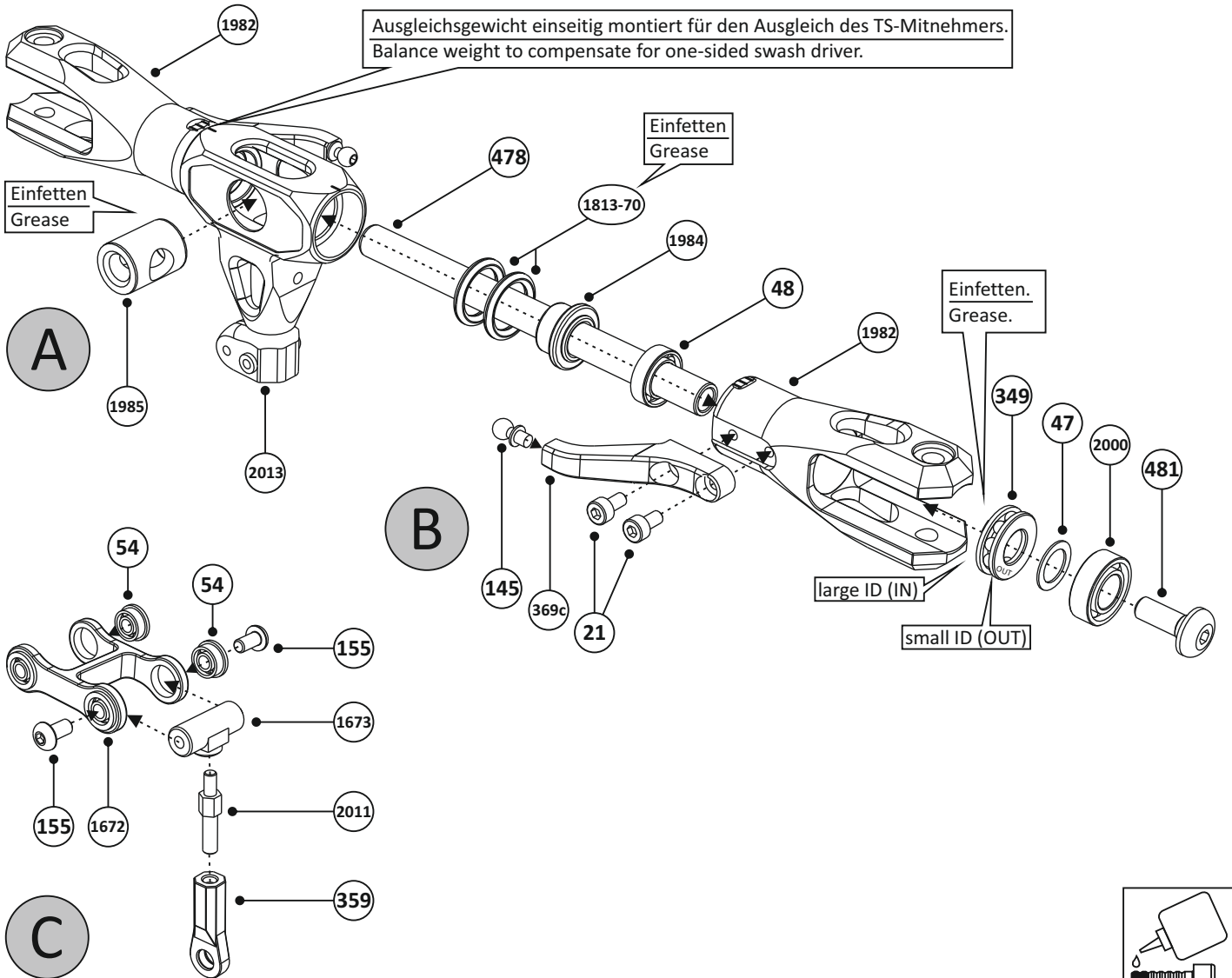

Normteile/Standard Parts

487 M3x25 Spezialschraube 1x
Special Screw

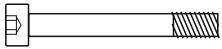

18 M3 Stopmutter 1x
Lock Nut



71 M3x10 Zylinderkopfschraube 1x
Socket Head Screw



155 M3x6 Rundkopfschraube 2x
Round Head Screw



1:1

1809 Anlenkgestänge 2x
(Links-Rechts Gewinde)
Head Linkage Rod
(Left and Right thread)



359 Kugelpfanne 4x
Ball Link

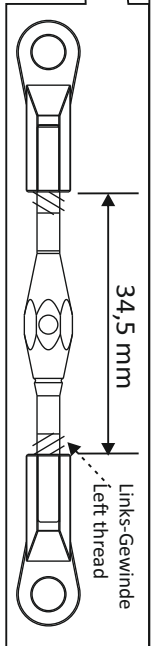
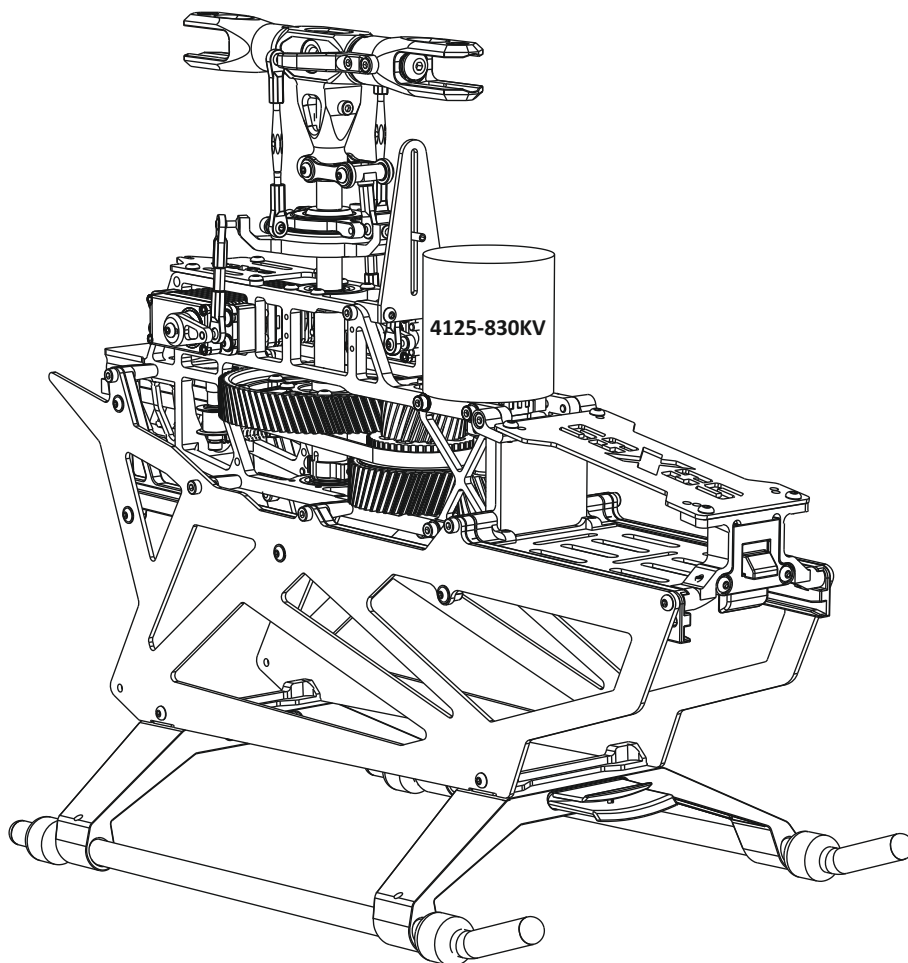
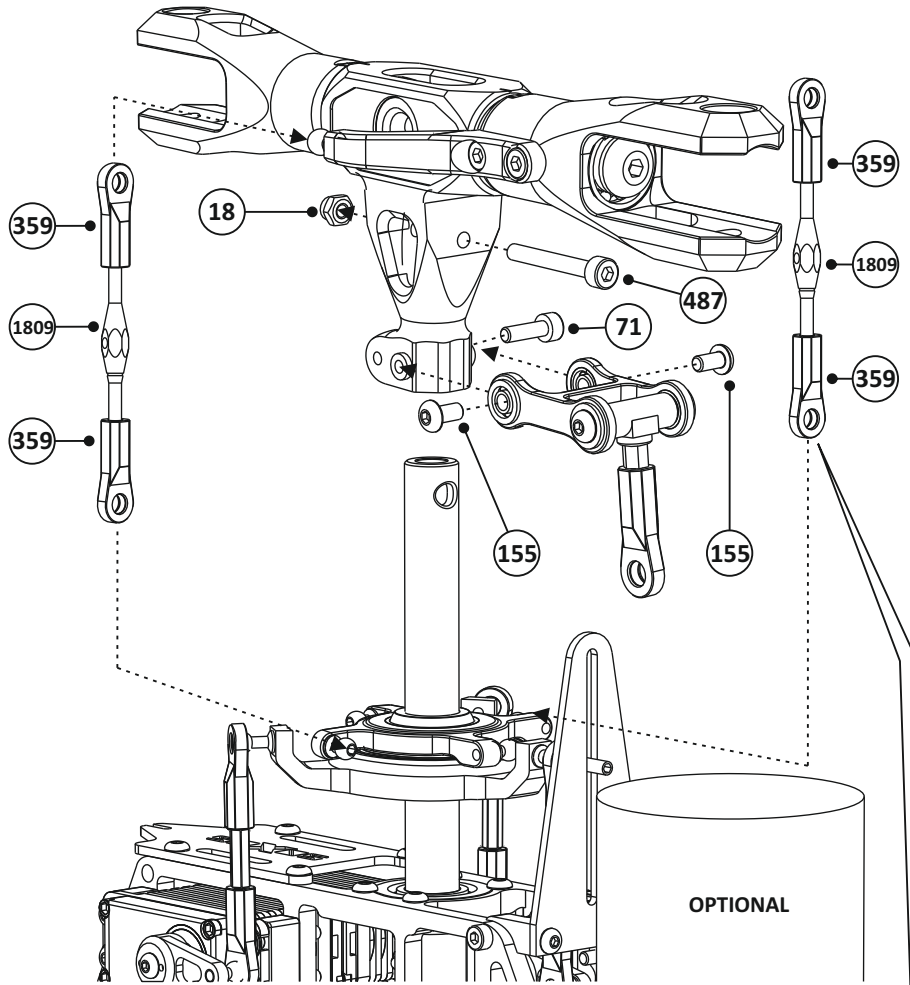
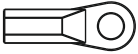

- 1764** Heckrohr 700 1x
Tail Boom 700

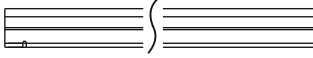
- 1765** Heckrotorgehäuse 1x
Tail Rotor Housing

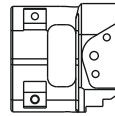

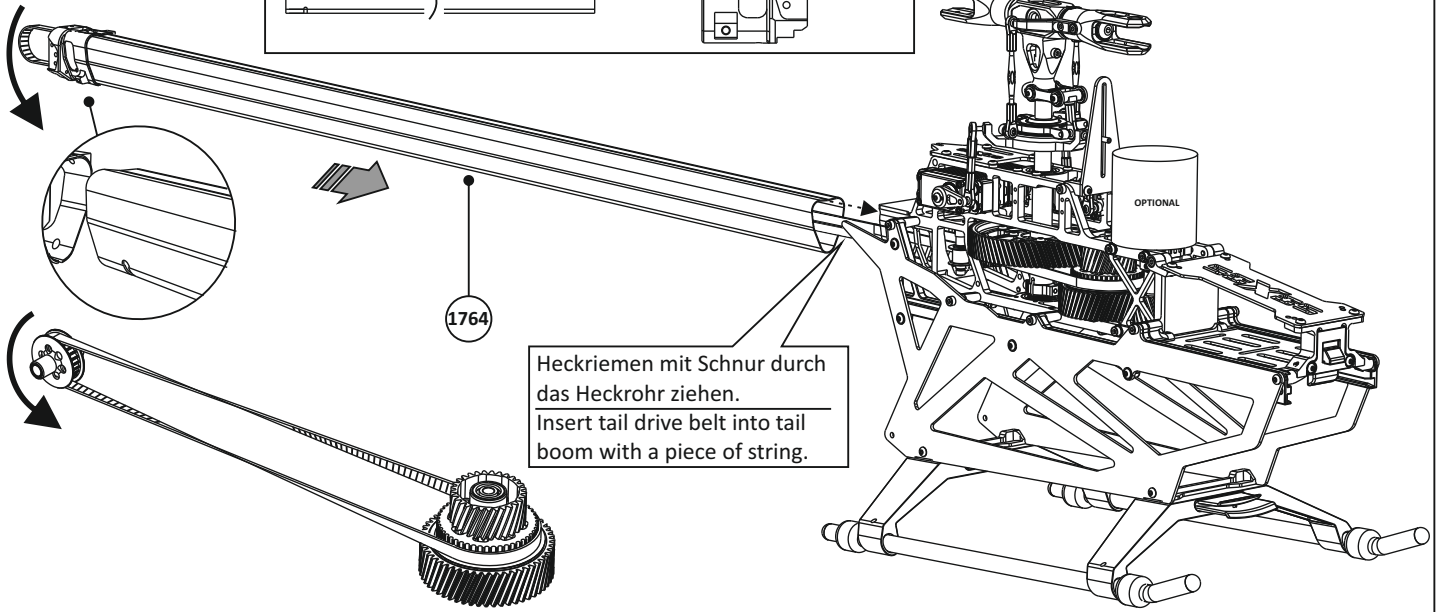

Normteile/Standard Parts

- 155**

M3x6

Rundkopfschraube

2x

Socket Head Screw

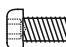

- 303**

M3x8

Zylinderkopfschraube

2x

Socket Head Screw



- 383**

8x12x3.5

Kugellager

1x

Ball Bearing



1:1

- 1771** Drehstablagerung Heckgehäuse 1x
Torque Tube Support Tail

- 1767** Seitenplatte Heckgehäuse 1x
Tail Rotor Housing Side Plates



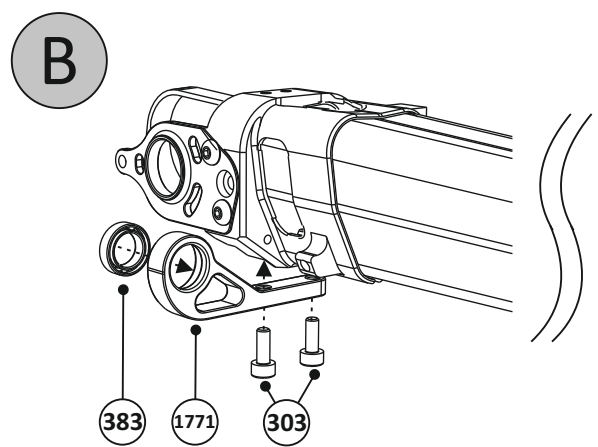
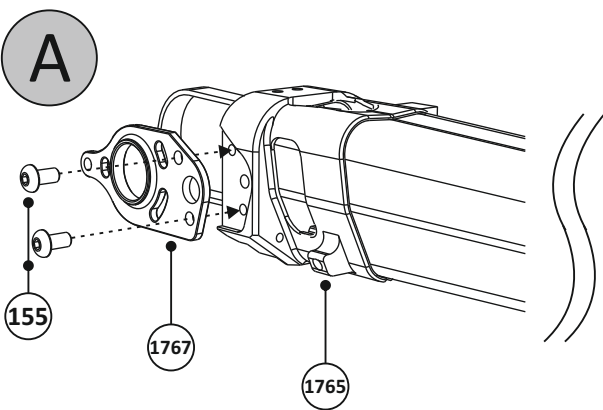

Normteile/Standard Parts

- 1787** M3x35 Rundkopfschraube 1x
Round Head Screw
- 17** M3x20 Zylinderkopfschraube 2x
Socket Head Screw
- 149** M3x12 Zylinderkopfschraube 1x
Socket Head Screw
- 71** M3x10 Zylinderkopfschraube 2x
Socket Head Screw
- 155** M3x6 Rundkopfschraube 1x
Round Head Screw
- 296** 7x11x3 Kugellager 2x
Ball Bearing
- 11** M3 U-Scheibe 1x
Washer

1:1

- 1668** Carbon Höhenleitwerk 1x
Carbon Stabilizer Fin
- 266** Steuerhebel 1x
Tail Lever
- 388a** Drehstab 1x
Torque Tube
- 1780** Drehstablagerung 1x
Torque Tube Support
- 1781** Halterklemme oben 2x
Upper Holder Clamp
- 1782** Höhenleitwerkhalterklemme unten 1x
Lower Stabilizer Fin Clamp
- 1667** Carbon Seitenleitwerk 1x
Carbon Vertical Fin
- 448** Höhenleitwerksdistanz 2x
Stabilizer Fin Spacer

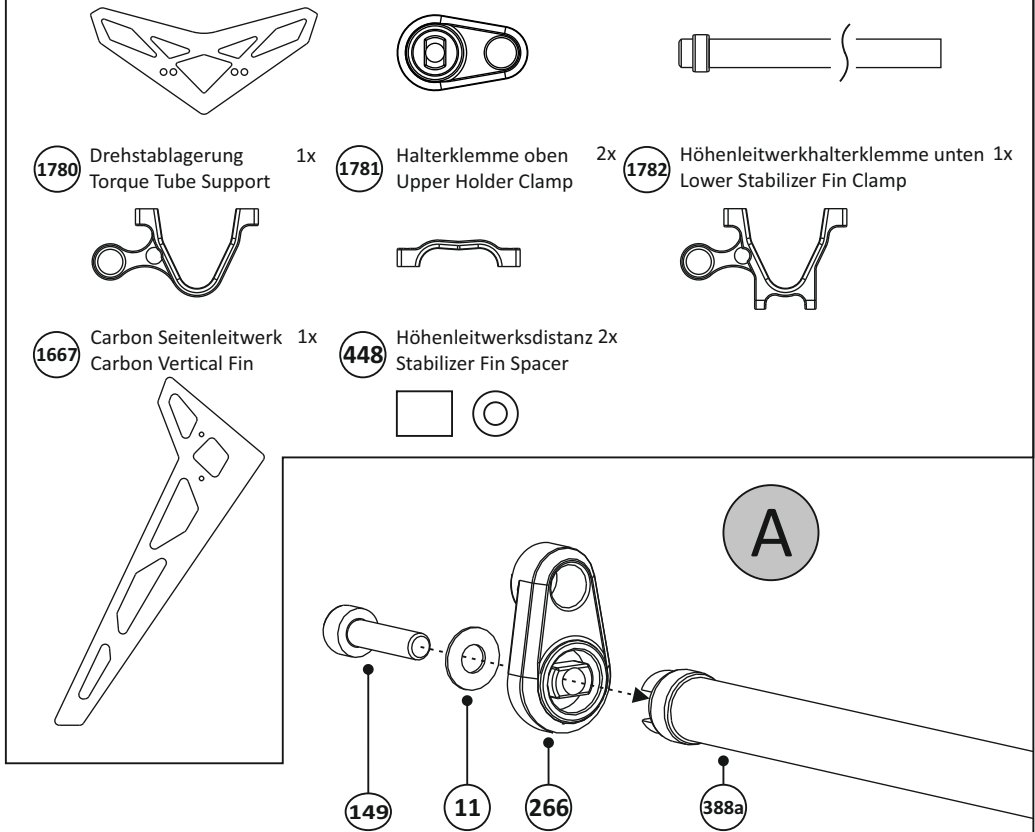

Diese Schrauben erst nach Montage der Heckstreben anziehen.
Clamp with these screws after having installed the tail brace tubes.

Drehstablagerung am Ende der Heckrohr Design-Linien montieren.
Torque Tube Support mount at the end of the tail boom design lines.

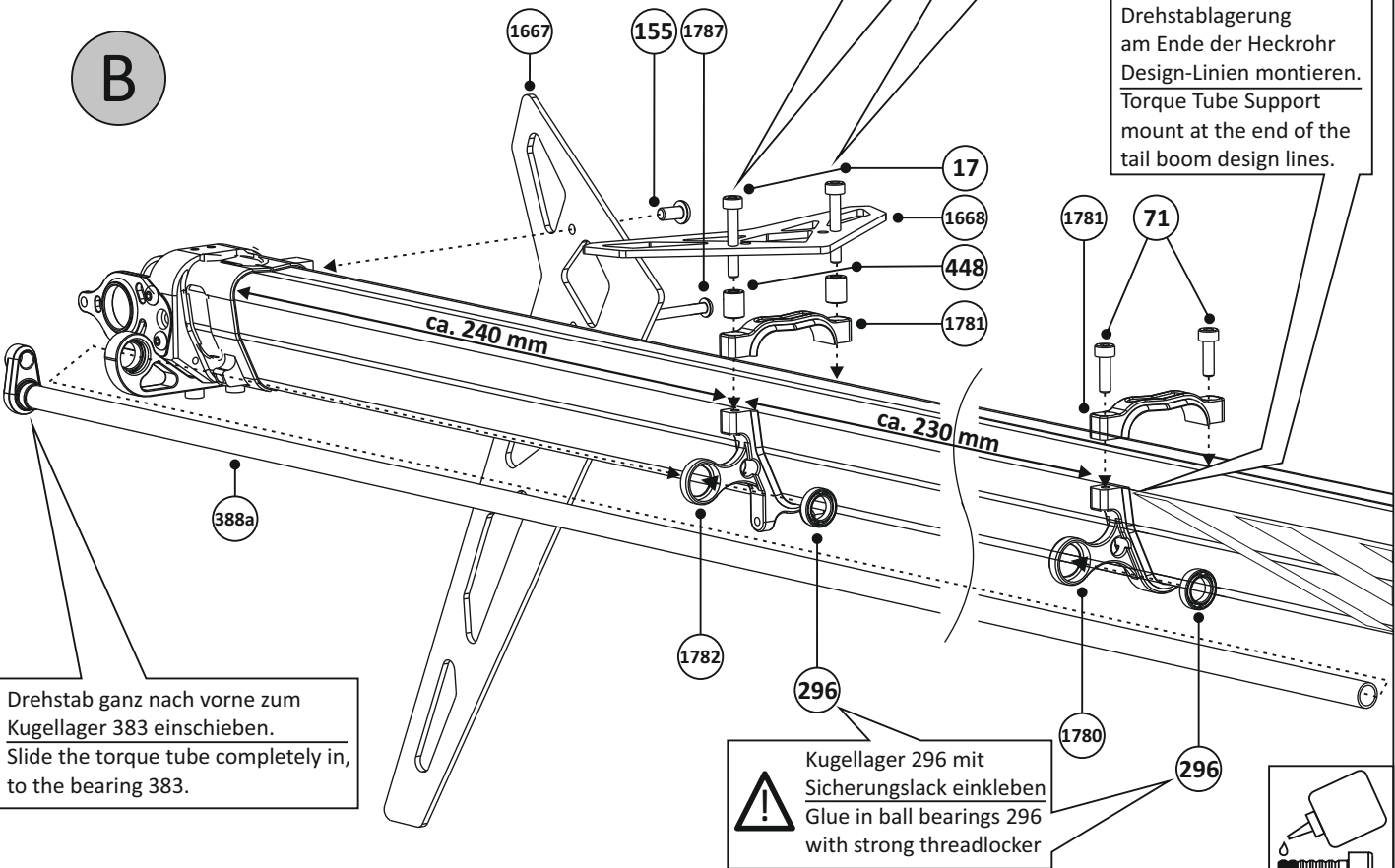

Drehstab ganz nach vorne zum Kugellager 383 einschieben.
Slide the torque tube completely in, to the bearing 383.

! Kugellager 296 mit Sicherungslack einkleben
Glue in ball bearings 296 with strong threadlocker



Normteile/Standard Parts

- 1600 M3x12 Rundkopfschraube 4x
Round Head Screw
- 71 M3x10 Zylinderkopfschraube 3x
Socket Head Screw
- 303 M3x8 Zylinderkopfschraube 1x
Socket Head Screw
- 11 M3 U-Scheibe 4x
Washer

1:1

- 1778 Halterklemme 1x
Holder Clamp
- 1776 Heckservohalter 1x
Tail Servo Holder
- 1658 Drehstabhebel 1x
Torque Tube Lever
- 41 Servoplättchen 2x
Servo Mounting Plates
- 1659-1663 Servo Einsatz 23Z,24Z,25Z,25Z/8
Insert Servo 23T,24T,25T,25T/8

Den passenden Einsatz zum Servo verwenden
Use the correct insert for the servo

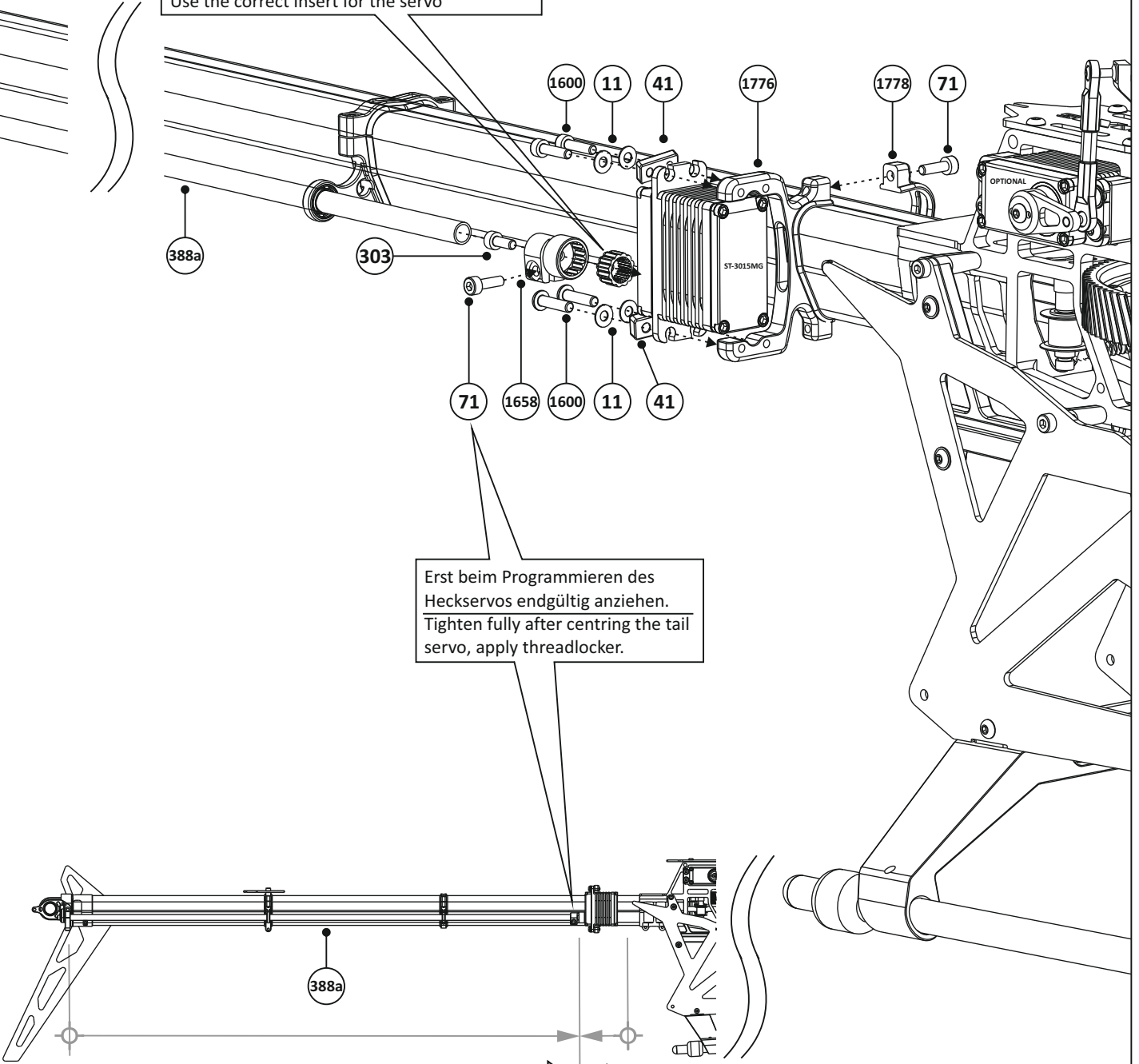

Erst beim Programmieren des Heckservos endgültig anziehen.
Tighten fully after centring the tail servo, apply threadlocker.

Drehstab ganz nach vorne schieben.
Push the Torque Tube all the way to the front.

Servo ganz nach hinten schieben.
Push the servo all the way back.

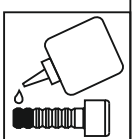

Normteile/Standard Parts

- | | |
|--|--|
| 145 M3x4.5 Kugelbolzen
Ball-End Screw 3x | 69 7.5x9.9x0.4 Passscheibe
Shim Washer 2x |
| 444 5x1 O-Ring 2x | 443 5.2x7.5x0.7 Passscheibe
Shim Washer 2x |
| 68 5x10x4 Kugellager
Ball Bearing 2x | 503 M2x5.5 Zylinderkopfschraube 2x
Socket Head Screw |
| 74g 6x10x3 Kugellager
Ball Bearing 2x | 303 M3x8 Zylinderkopfschraube 2x
Socket Head Screw |

- | | |
|---|---|
| 1711-1 Heckrotornabe
Tail Rotor Hub 1x | 1704 Blatthalter Heckrotor
Blade Holder Tail Rotor 2x |
| 151 5x10x4 Drucklager
Thrust Bearing 2x | 1773 Hecksteuerbrücke
Tail Pitch Control 1x |
| large ID (IN) small ID (OUT) | |
| 70 3x7.5x1 Unterlegscheibe 2x
Washer | 268 Hecksteuerbrückenarme 2x
Tail Pitch Control Arms |

1:1

Punkt auf 268 muss Richtung Schraubenkopf 503 sein.
Raised dot on 268 must be in direction screw head 503.

Kugellager werksseitig bereits montiert.
Ball bearing already assembled.

Einfetten.
Grease.

Werksseitig bereits montiert und gesichert.
Factory assembled and secured.

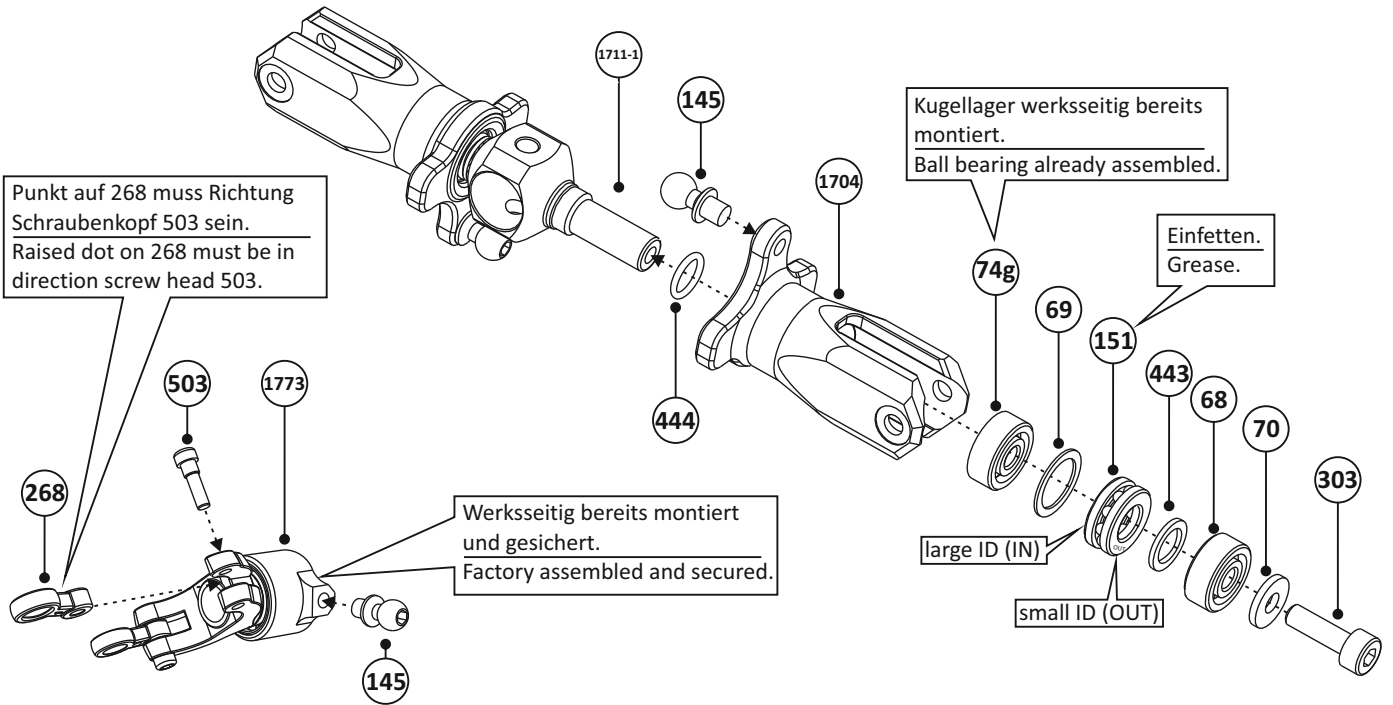

Normteile/Standard Parts

- | | |
|---|--|
| 33 M4x4 Gewindestift
Set Screw 1x | 1714 Dämpfergummi
Damper Rubber 4x |
|---|--|

1:1

- | | |
|------------------------------------|---|
| 1715 3x13 Bolzen
Bolt 1x | 1768 Heckrotorwelle
Tail Rotor Shaft 1x |
|------------------------------------|---|

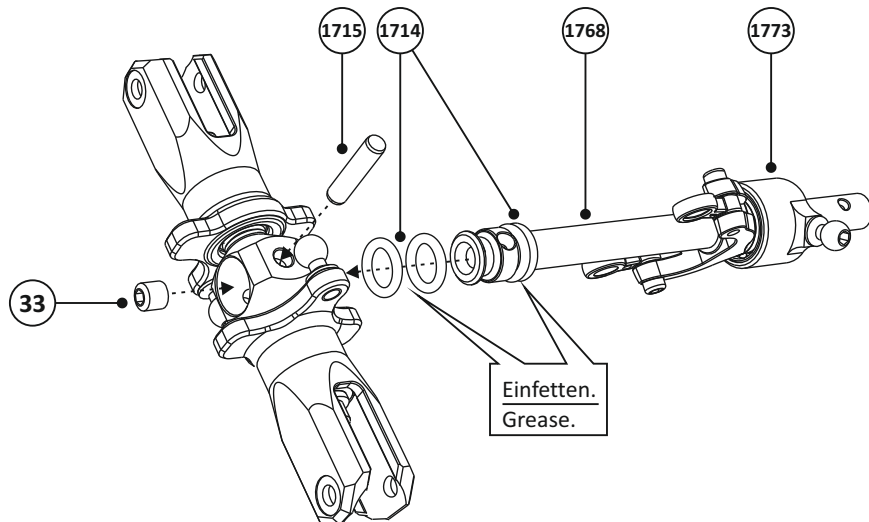

Einfetten.
Grease.



Normteile/Standard Parts

1600	M3x12 Rundkopfschraube 1x Round Head Screw	376	6x13x5 Flanschlager Flanged Bearing	2x	1769	Heckantriebsrolle 26Z Tail Drive Pulley 26T	1x	1772	Kugellagerhalter Bearing Stand	1x
155	M3x6 Rundkopfschraube 6x Round Head Screw	1802	3x8x3 Kugellager Ball Bearing	2x	1770	Distanz Heckgehäuse Spacer Tail Rotor Housing	1x	1767	Seitenplatte Heckgehäuse Tail Rotor Housing Side Plates	1x
33	M4x4 Gewindestift Set Screw				1774	2x10 Bolzen Pin	1x			

1:1

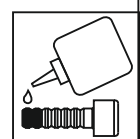
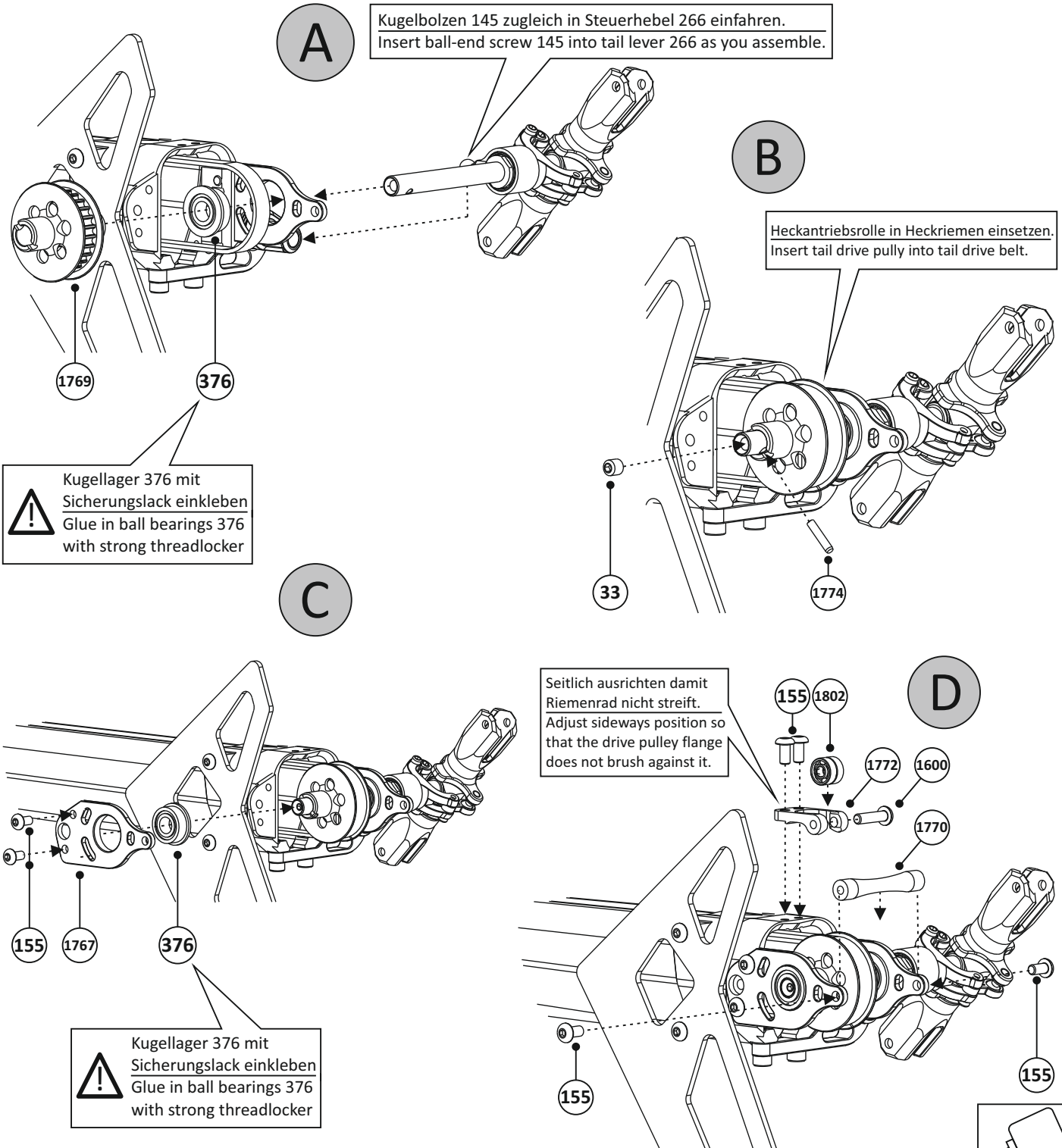

Normteile/Standard Parts

- 77 M3x16 Zylinderkopfschraube 2x
Socket Head Screw



1:1

! Heckriemen spannen: Riemen spannen, bis Riemenspanner vollständig am äusseren Anschlag ist, aber nicht überspannen!
Tighten tail drive belt: Tension the belt until the belt tensioner is touching the outer stop, but do not over tension!

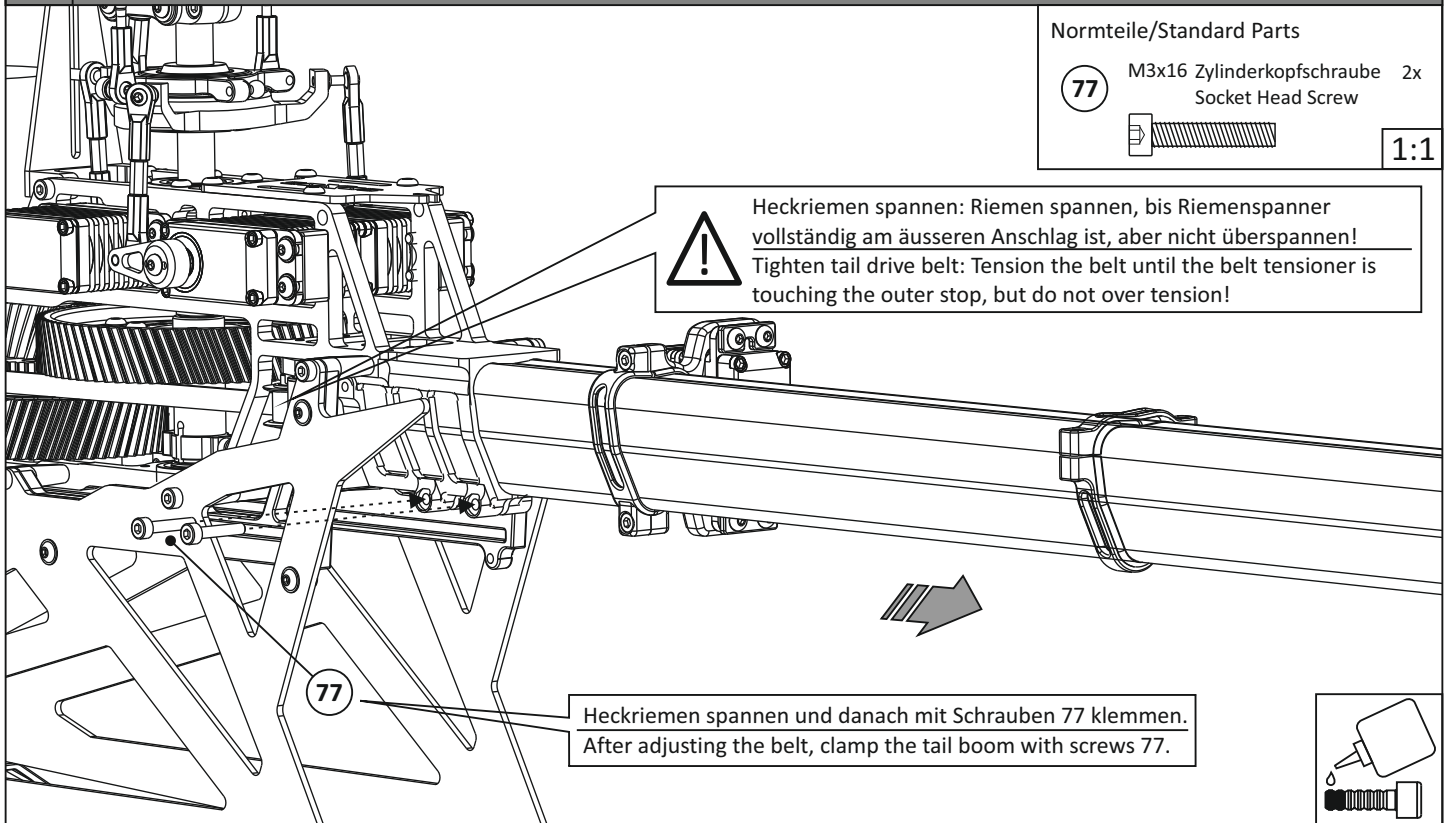

Heckriemen spannen und danach mit Schrauben 77 klemmen.
After adjusting the belt, clamp the tail boom with screws 77.

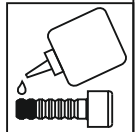

Normteile/Standard Parts

- 1684 M3x10 Rundkopfschraube 1x
Round Head Screw



- 354 M3x8 Rundkopfschraube 2x
Round Head Screw



- 54 3x7x3 Flanschlager 2x
Flanged Bearing



1:1

- 1805 Federhülse 1x
Spring Sleeve

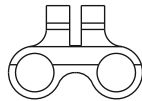

- 1695 Stift 2.5x15mm 2x
Pin



- 1977 Haubenhalter 1x
Canopy Holder Carbon

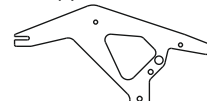

- 1806 Sicherheitshebel 1x
Safety Lever



- 1807 Stehbolzen 1x
Stud Bolt

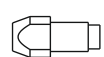

- 1808 Mutter 1x
Nut



- 1804 Druckfeder 2x
Pressure Spring



B

Mit Sekundenkleber eindrehen!
Use CA to secure the pins!

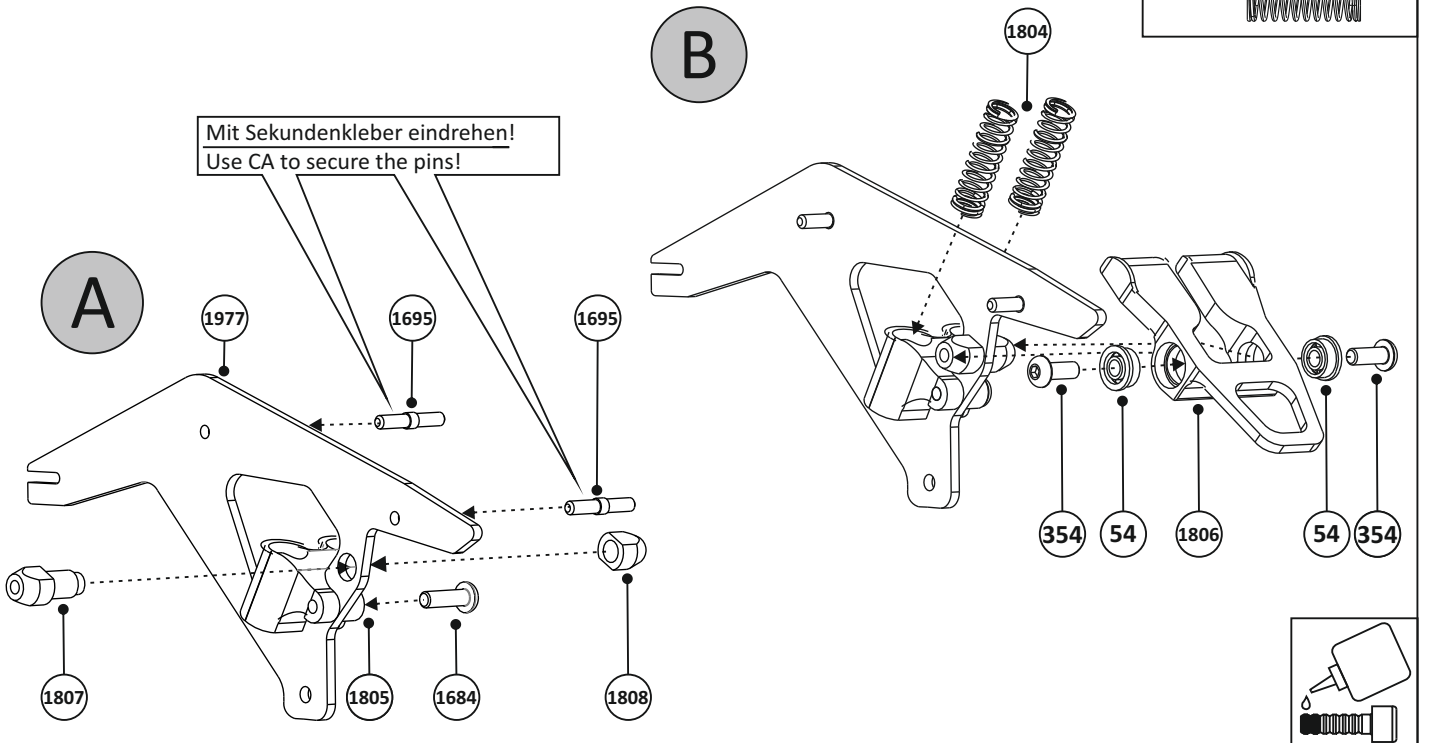

Normteile/Standard Parts

18 M3 Stopmutter
Lock Nut 2x

71 M3x10 Zylinderkopfschraube
Socket Head Screw 4x

303 M3x8 Zylinderkopfschraube
Socket Head Screw 2x

1:1

1778 Halterklemme
Holder Clamp 1x



1779 Halterklemme M3
Holder Clamp M3 1x



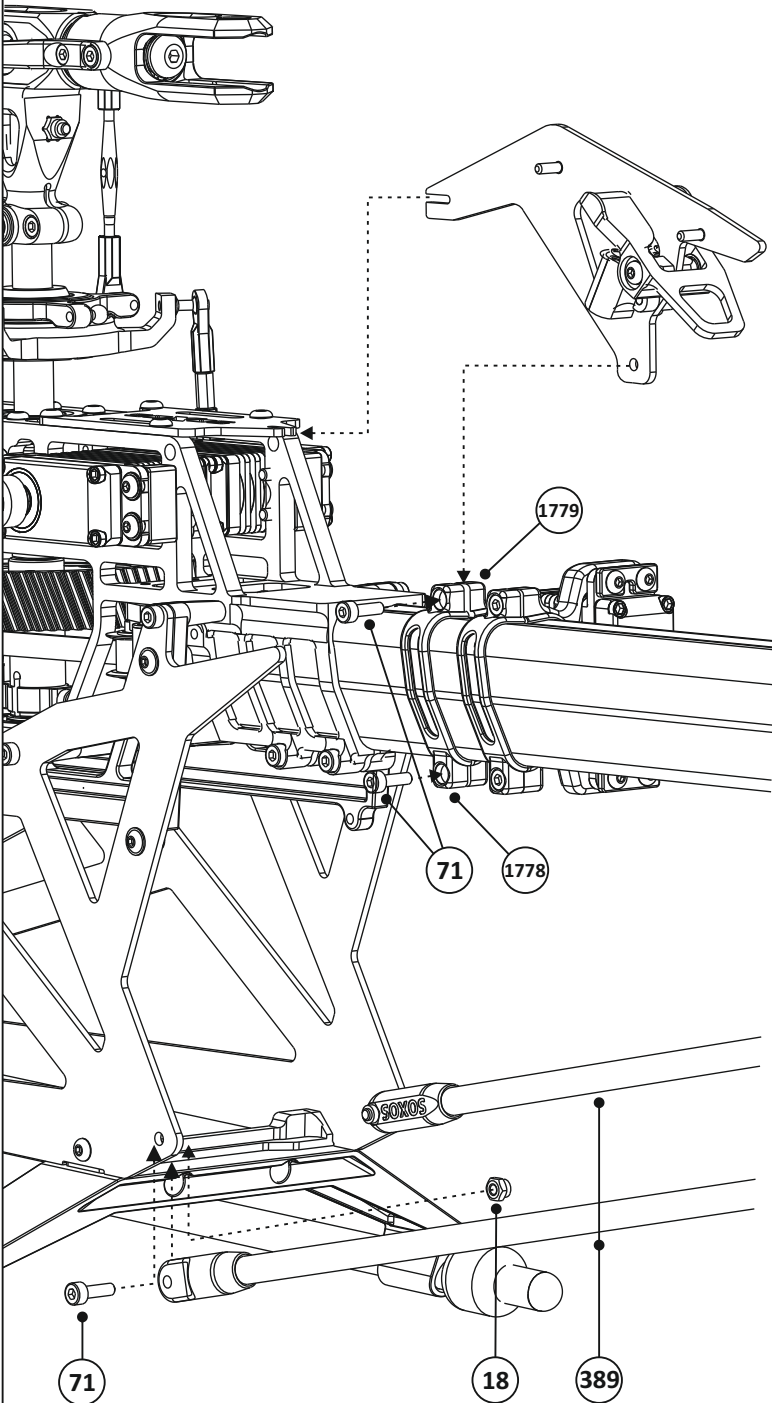
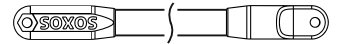

389 Heckstrebe
Tail Brace Tube 2x

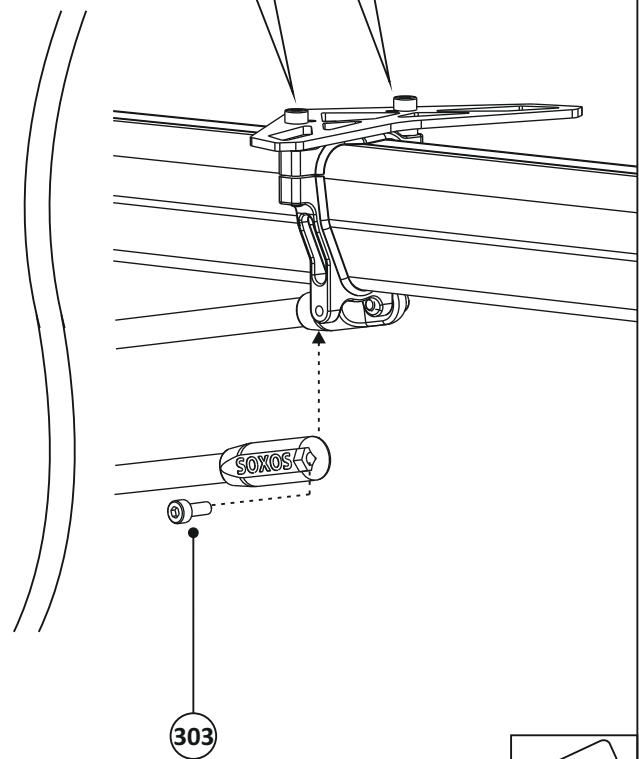

Diese Schrauben erst nach Montage
der Heckstreben anziehen.
Clamp with these screws after
having installed the tail brace tubes.



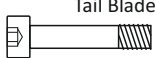
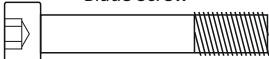

Normteile/Standard Parts

- | | |
|--|--|
| <p>510 M3x16 Heckrotorblattschraube 2x
Tail Blade Screw</p>  | <p>423 M5x30 Blatthalterschraube 2x
Blade Screw</p>  |
| <p>18 M3 Stopmmutter 2x
Lock Nut</p>  | <p>427 M5 Stopmmutter 2x
Lock Nut</p>  |

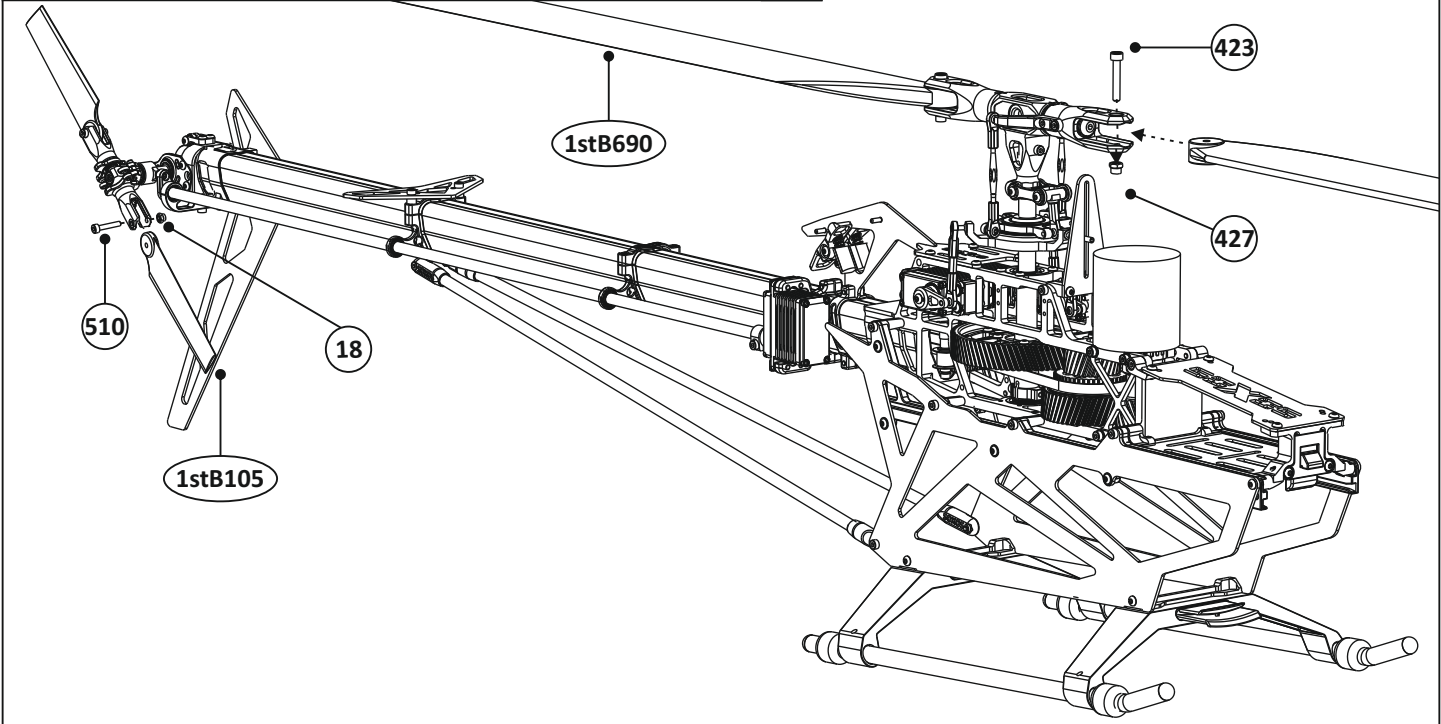
1:1

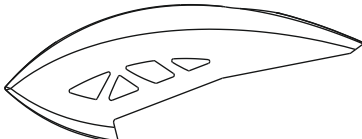

- | | |
|---|---|
| <p>259
C6.1 Haube Strike 6.1
Canopy Strike 6.1</p>  | <p>517 Akkuplatte 1x
Battery Plate</p>  |
|---|---|

Justieren Sie die Balance des Helikopters mit der Positionierung des Akkus auf der Akkuplatte (inkl. Haube). Verwenden Sie das mitgelieferte Klettband, um den Akku zu sichern. Der Akku darf sich während des Fluges nicht verschieben.
Adjust the helicopter's balance with the position of the battery pack on the battery plate (incl. canopy). Use the supplied Velcro to secure the battery, the pack must not shift during flight.

