

Telecentric LED Moduls

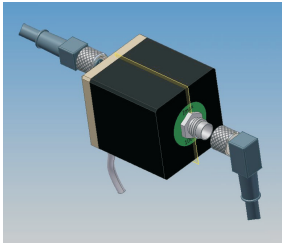

Short description:

- Object telecentric system with aspherical optics
- Homogenous illumination and little vignetting values with own optics development and production
- Robust industrial implementation
- Input voltage: DC 5 - 30 V
Short-circuit proof: AC 90 - 230 V
- Modular concept, exchange of optical heads and illumination moduls
- Suitable for continous and flash light
- TZ supply and illumination
Current 40 and 1.000 mA
- dxf drawings on request

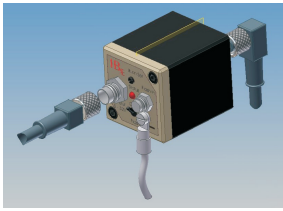
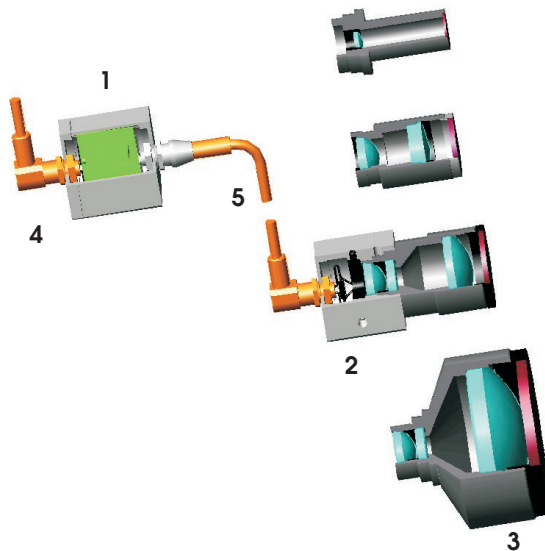

Completeset

TZ Supply (1)

Electronic supply with constant current in PWMtechniqueforcontinuousandflash light.

Current adjustable from 0 % - 100 % max. 100 and 1000 mA

Short-circuit-proof,proofforexcess voltage, reverse protection integrated

Available in different object diameters:

TZ-BEL-OP 23:	Up to Ø 16 mm
TZ-BEL-OP 30-S1:	Up to Ø 24 mm
TZ-BEL- OP 30:	Up to Ø 24 mm
TZ-BEL-OP 32:	Up to Ø 24 mm
TZ-BEL-OP 44:	Up to Ø 32 mm
TZ-BEL-OP 55:	Up to Ø 44mm

TZ Illumination Modul (2)

Modul with ultrabright Led's and diffuser available with different colors as red, blue, green, amber, yellow, white and NIR

The intensity can be adjusted at the current supply.

TZ Cables (4/5)

TZ Specialized Optics (3)

Optics for different object diameters. This specialized optics generates perfect parallel and homogenous light for your measurement purpose.

TZ-BEL-OP 23

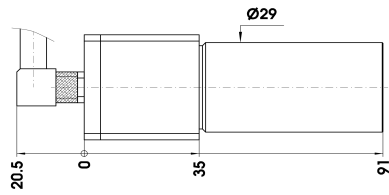

TZ-BEL-OP 30

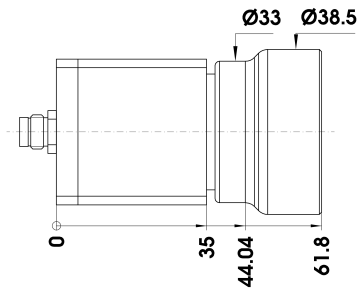

TZ-BEL-OP 44

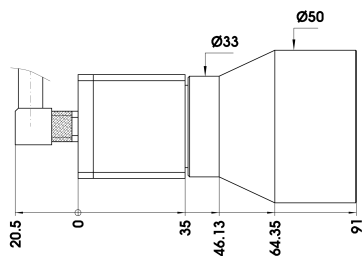

TZ-BEL-OP 55

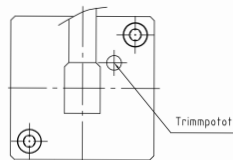
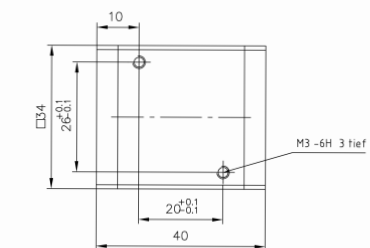
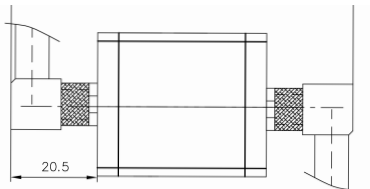
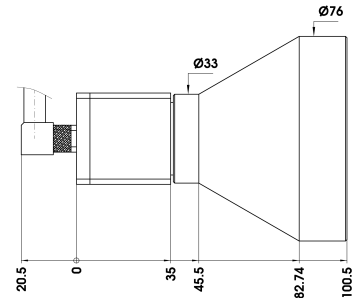

TZ-BEL-OP30-S1

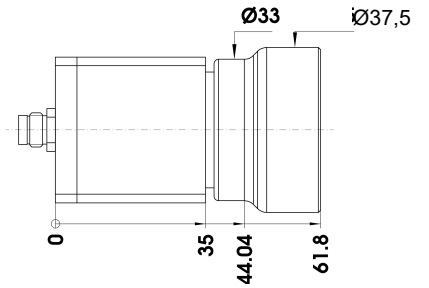

TZ-BEL-OP 32

