

Gesamtbreite (Total dimension) = $A+14$

Mass (Dimension) = A

A

Detail A

6.2

Stoffbreite (Fabric dimension) = $A-50$

Mass (Dimension) = D^*

*Standard = Stoffbreite (Fabric width) + 68

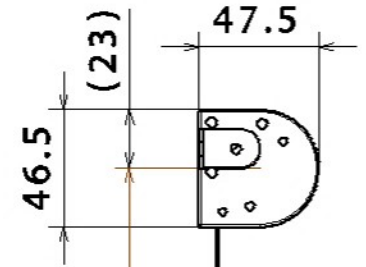

Mass (Dimension) = B

Einhängehaken (Hook)
= Standard E1